

T. 29., S., R. 14W., W.M.

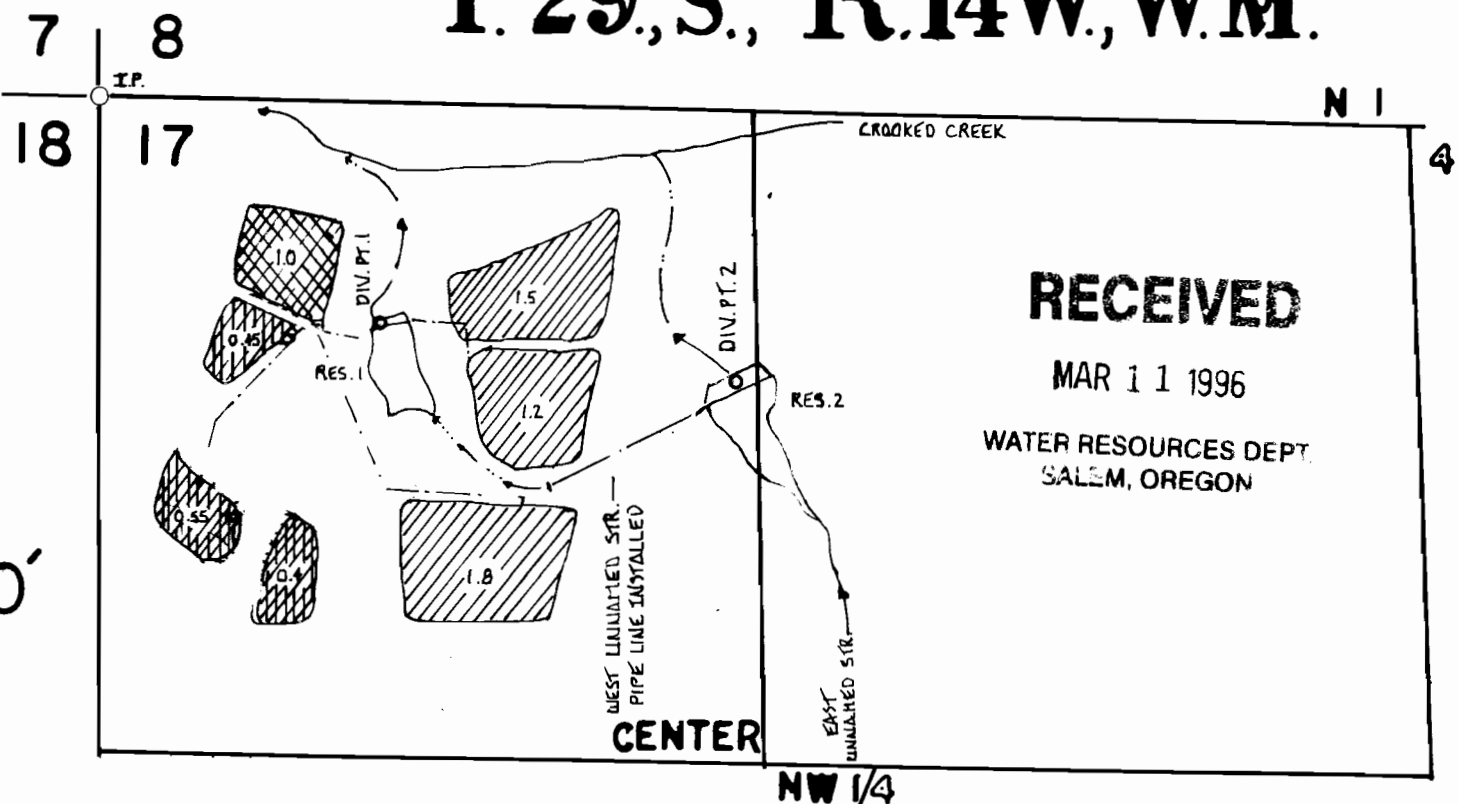

RECEIVED

MAR 11 1996

WATER RESOURCES DEPT.
SALEM, OREGON

1" = 400'

Div. Pt. Res. 1 S. 430 & E. 600-NW cor S. 17 Div. pt. Res. 2 S. 550 & E. 1285-Nw cor. S. 17

LEGEND

FINAL PROOF SURVEY UNDER

New place of use per Transfer No. T-6079

Continued place of use cert. No. 31372

Place of use per. permit No. 50716

N O T E: ALL BOGS, RESEVOIRS AND DIVERSION POINTS ARE BUILT

Application Number R-69546 & 69547

Permit Number R-11150 & 50716

Transfer Number T-6079

ROBERT L. & HELEN M. ATEN

This map is for the purpose of identifying the location of the water right only and is not intended to provide legal dimensions or location of property ownership lines.

