

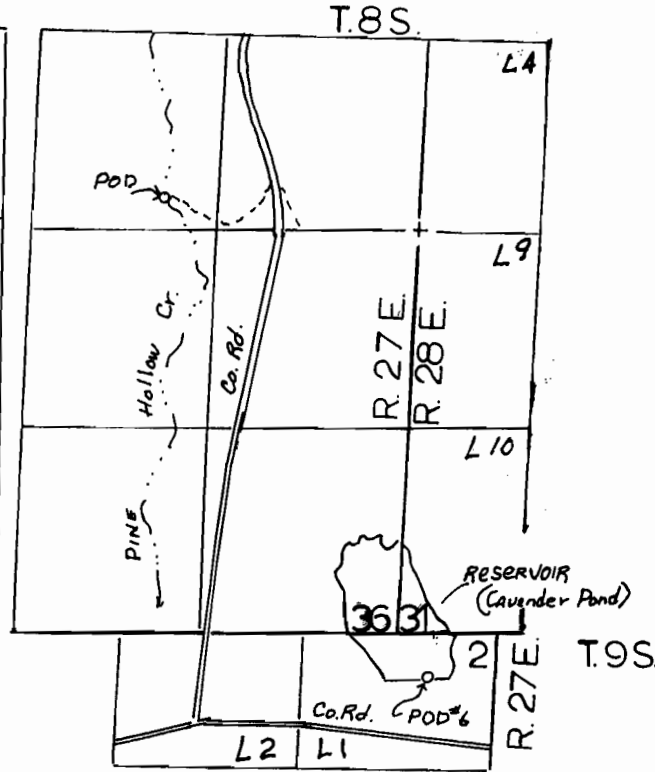

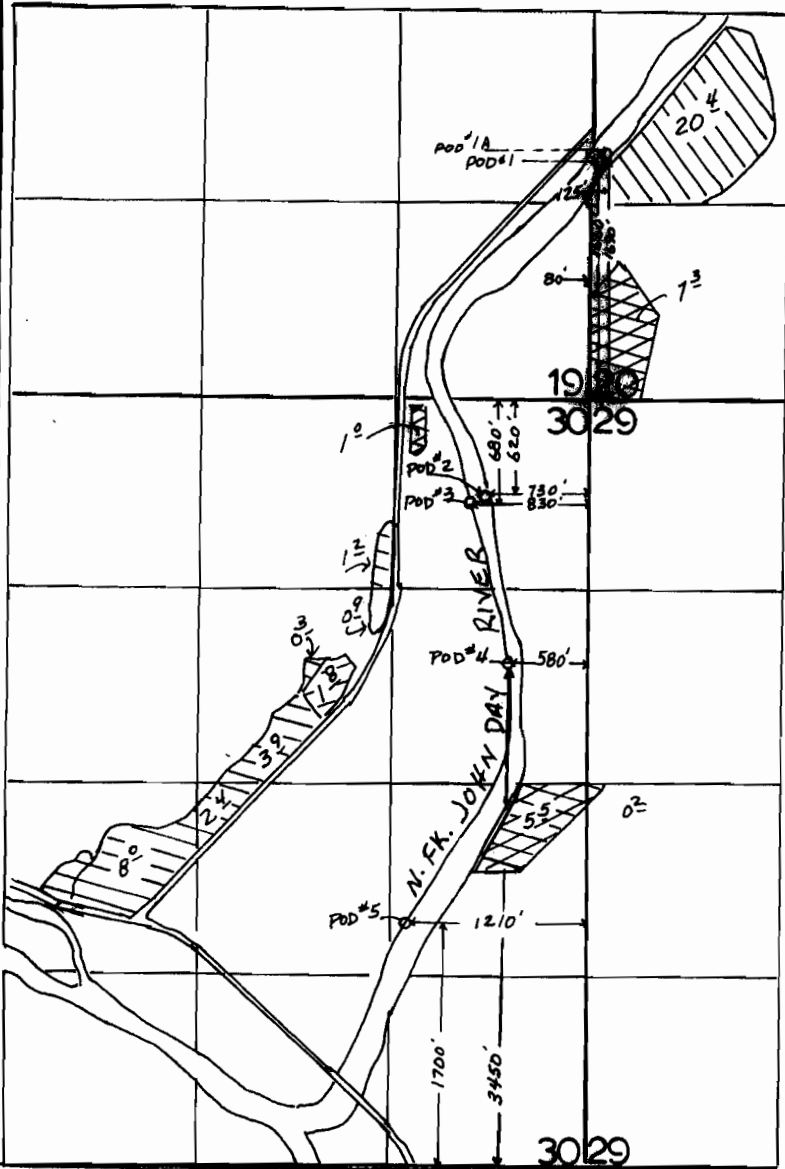



T. 9 S., R 26 E., W.M.

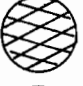

-  P-49637, FROST PROTECTION NFJD RIVER SUPPL' IRR. RES. P# 8654
-  P-49637, FROST PROTECTION
-  P-49637, IRR. & FROST PROTECTION, NFJD RIV. DEFICIENCY FROM RESERVOIR
-  P-49637, FROST PROTECTION NFJD RIV.
- 

POD #6 (RES.DIV.) 300'S. & 220'E. FROM THE SW COR. SEC. 31

**FINAL PROOF SURVEY**  
UNDER

Application No. 68390.. Permit No. 49637.....

**IN NAME OF**

HITSELBERGER FAMILY TRUST

.....THOMAS ORCHARDS, INC.....

Surveyed MAR. 16.. 2000., by J. MILLER.....



1" = 1320'