

- Legend**
- Pump Station
 - Drip Tube Water Distribution Manifold
 - Canal
 - Railroad
 - Water Distribution Mainline
 - Water Distribution Sub-Mainline
 - Township and Range Boundary
 - Section Boundary
 - Water Right Area

1/4 1/4 Section Water Right Acres

1 inch equals 200 feet

0 100 200 400 600 800 1,000 Feet

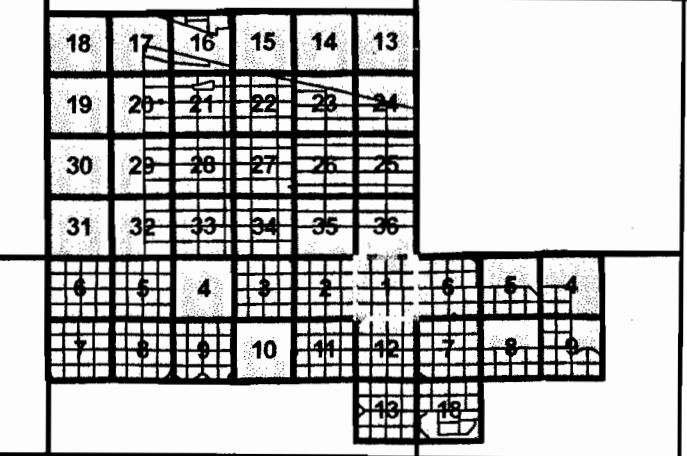

THIS MAP WAS PREPARED FOR THE PURPOSE OF IDENTIFYING THE LOCATION OF A WATER RIGHT ONLY AND IS NOT INTENDED TO PROVIDE LEGAL DIMENSIONS OR LOCATION OF PROPERTY OWNERSHIP LINES

Point of Diversion:
 Lot 7 NE1/4NW1/4, Section 2, T4N, R25E, W.M.;
 South 88 degrees 22 minutes, 46 seconds west, 2829 feet from the NE corner, Section 2

Potlatch Corporation
 Hybrid Poplar Program
 T3N R26E Section 1
 Final Proof Map
 Water Rights Transfer Application
 T8618
 From Certificate 74193

Drawn By: ACB
 Date: 02/29/07
 Projection: US State Plane North
 NAD2011 FT

COBU MAP # 0178 2.584

RECEIVED
 FEB 8 2007
 WATER RESOURCES DEPT
 SALEM, OREGON

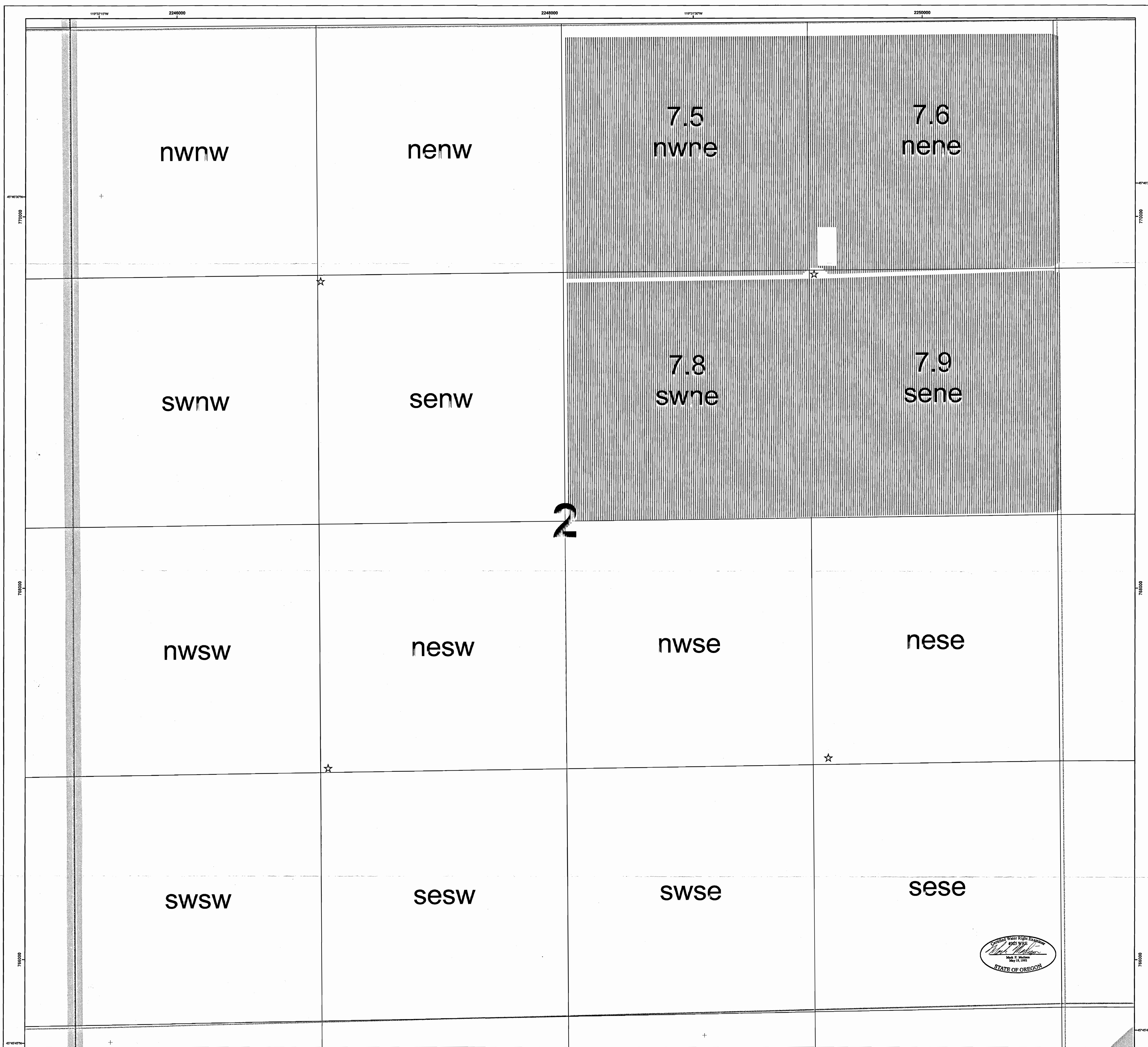

- Legend**
- Pump Station
 - Drip Tube Water Distribution Manifold
 - Canal
 - Railroad
 - Township and Range Boundary
 - Section Boundary
 - Water Right Area
- 7.3/7.9 1/4 Section Water Right Acres

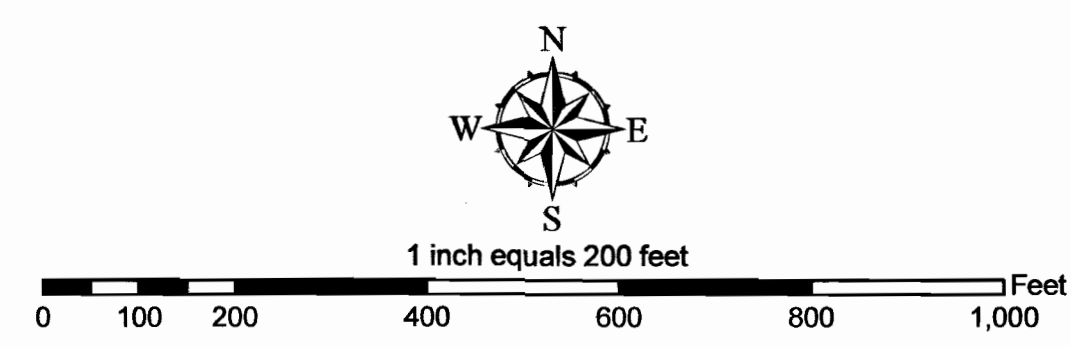

18	17	16	15	14	13
19	28	27	26	25	24
30	29	28	27	26	25
31	32	33	34	35	36

THIS MAP WAS PREPARED FOR THE PURPOSE OF IDENTIFYING THE LOCATION OF A WATER RIGHT ONLY AND IS NOT INTENDED TO PROVIDE LEGAL DIMENSIONS OR LOCATION OF PROPERTY OWNERSHIP LINES.

Point of Diversion:
 Lot 7 NE1/4NW1/4, Section 2, T4N, R25E, W.M.;
 South 86 degrees 22 minutes, 46 seconds west, 2829 feet from the NE corner, Section 2

Potlatch Corporation
 Hybrid Poplar Program
 T3N R26E Section 2
 Final Proof Map
 Water Rights Transfer Application
 T8618
 From Certificate 74193

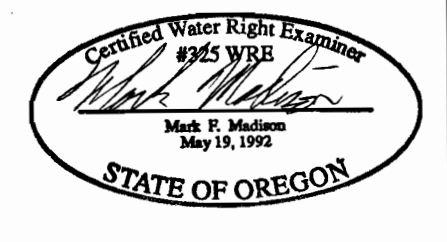

RECEIVED
 SEP 30 2005
 WATER RESOURCES DEPT
 SALEM, OREGON

COBU MAP #
 0178

3 of 4

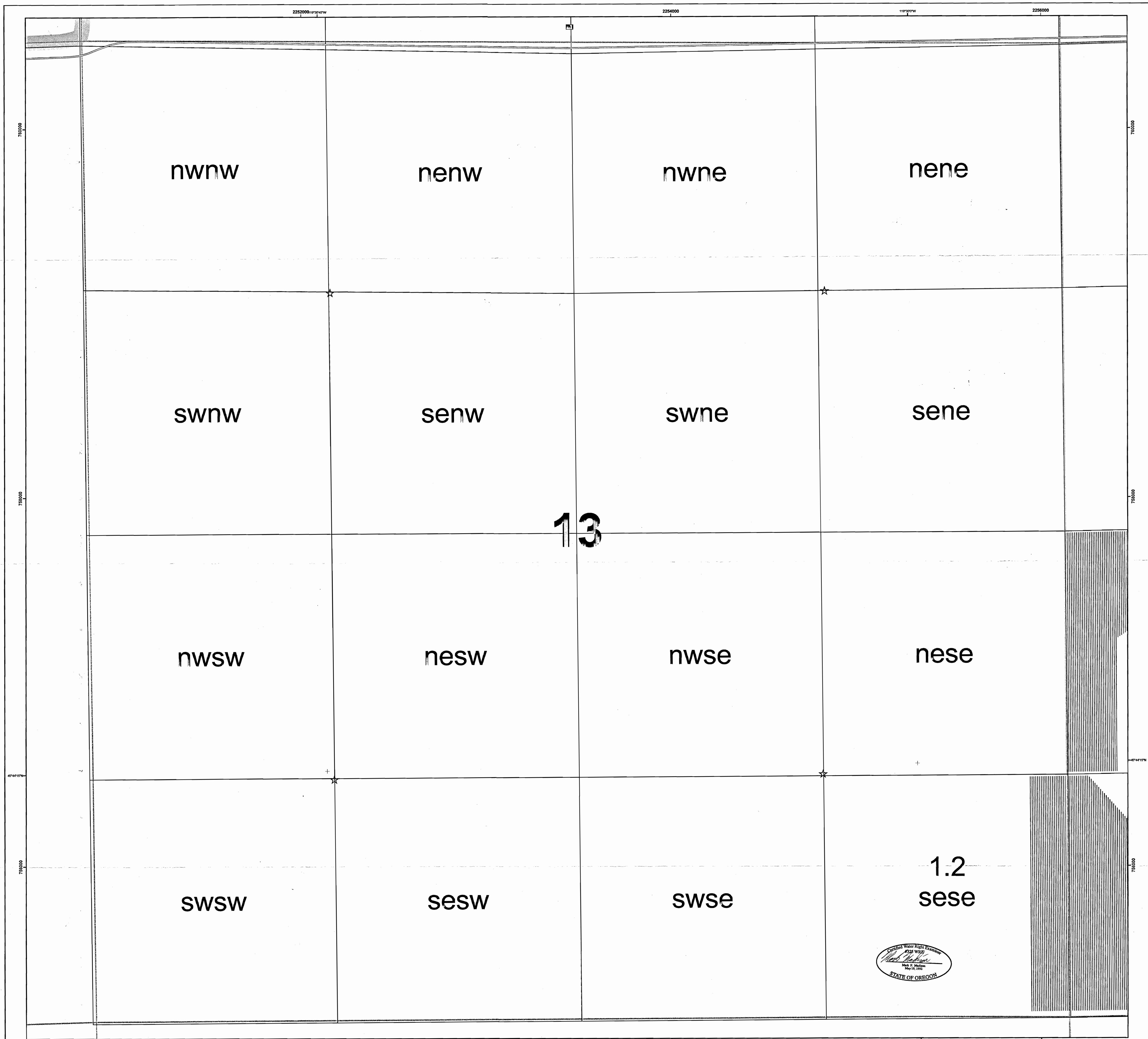

- Legend**
- Pump Station
 - Drip Tube Water Distribution Manifold
 - Canal
 - Railroad
 - 1/4 1/4 Section Water Right Acres
 - Township and Range Boundary
 - Section Boundary
 - Water Right Area

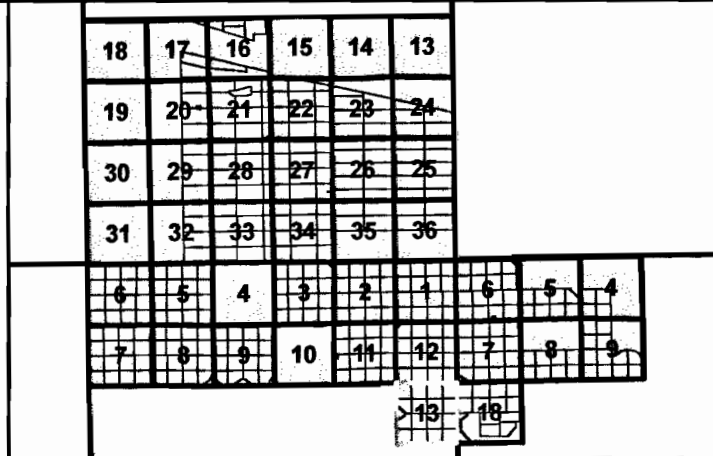
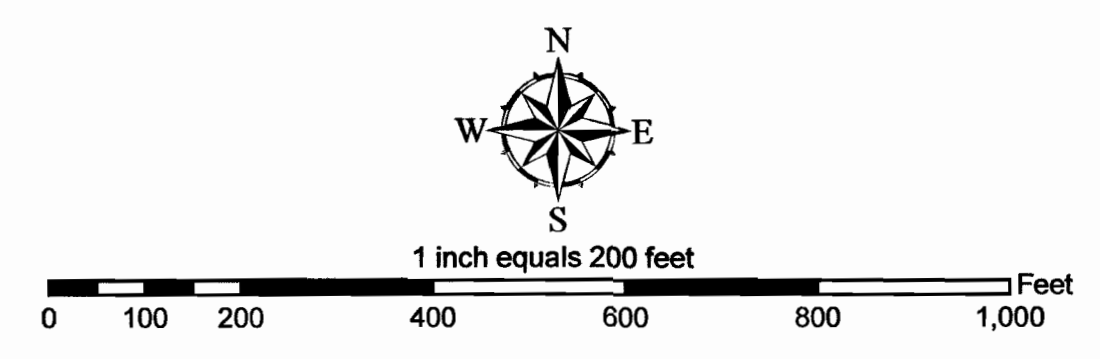

THIS MAP WAS PREPARED FOR THE PURPOSE OF IDENTIFYING THE LOCATION OF A WATER RIGHT ONLY AND IS NOT INTENDED TO PROVIDE LEGAL DIMENSIONS OR LOCATION OF PROPERTY OWNERSHIP LINES

Point of Diversion:
 Lot 7 NE 1/4NW1/4, Section 2, T4N, R25E, W.M.;
 South 86 degrees 22 minutes, 46 seconds west, 2829 feet from the NE corner, Section 2

Potlatch Corporation
 Hybrid Poplar Program
 T3N R26E Section 13
 Final Proof Map
 Water Rights Transfer Application
 T8618
 From Certificate 74193

Drawn By: ADP
 Date: 09/25/04
 Projection: GCS North America
 NAD83, FT

COBU MAP #
 0178

RECEIVED
 SEP 30 2005
 WATER RESOURCES DEPT
 SALEM, OREGON

4 of 4



Certified Water Right Examiner
 Mark P. Miller
 State of Oregon

- Legend**
- Pump Station
 - Drip Tube Water Distribution Manifold
 - Canal
 - Railroad
 - 1/4 1/4 Section Water Right Acres
 - Township and Range Boundary
 - Section Boundary
 - Water Right Area

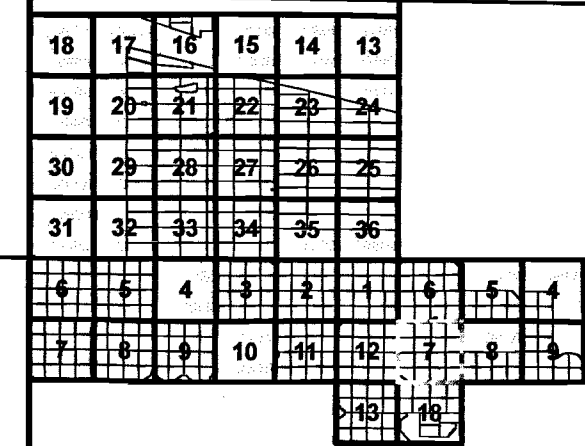
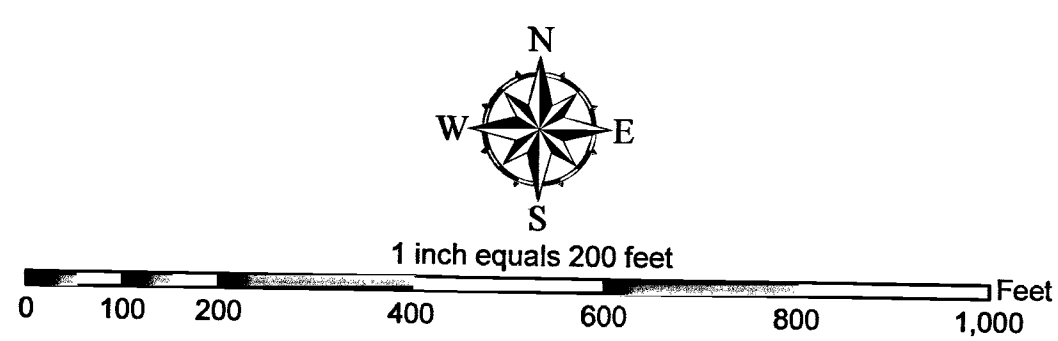

THIS MAP WAS PREPARED FOR THE PURPOSE OF IDENTIFYING THE LOCATION OF A WATER RIGHT ONLY AND IS NOT INTENDED TO PROVIDE LEGAL DIMENSIONS OR LOCATION OF PROPERTY OWNERSHIP LINES

Point of Diversion:
 Lot 7 NE1/4NW1/4, Section 2, T4N, R25E, W.M.;
 South 86 degrees 22 minutes, 46 seconds west, 2829 feet from the NE corner, Section 2

Pottlatch Corporation
 Hybrid Poplar Program
 T3N R27E Section 9
 Final Proof Map
 Water Rights Transfer Application
 T8618
 From Certificate 74193

Drawn By: ADH
 Date: 08/23/08
 Projection: US State Plane North
 NAD83, FT

RECEIVED
 SEP 3 0 2005
 WATER RESOURCES DEPT
 SALEM, OREGON

COBU MAP #
 0178

2 of 4



Legend

- Pump Station
- Drip Tube Water Distribution Manifold
- Canal
- Railroad
- 1/4 1/4 Section Water Right Acres
- Township and Range Boundary
- Section Boundary
- Water Right Area

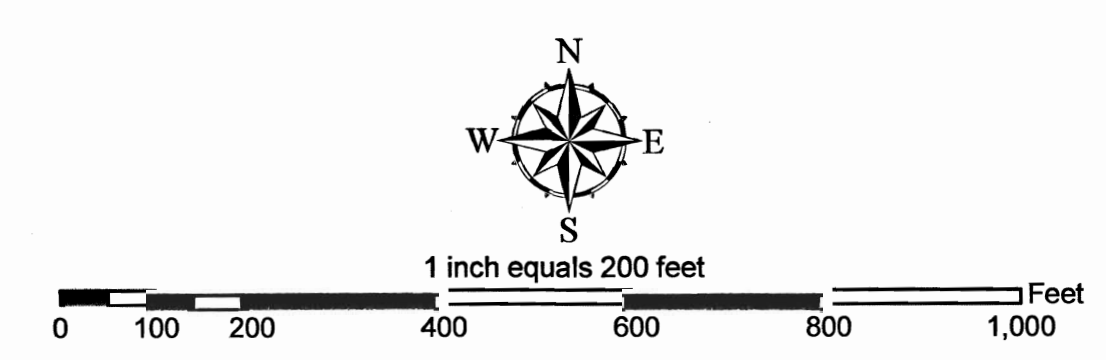

18	17	16	15	14	13
19	20	21	22	23	24
30	29	28	27	26	25
31	32	33	34	35	36

THIS MAP WAS PREPARED FOR THE PURPOSE OF IDENTIFYING THE LOCATION OF A WATER RIGHT ONLY AND IS NOT INTENDED TO PROVIDE LEGAL DIMENSIONS OR LOCATION OF PROPERTY OWNERSHIP LINES

Point of Diversion:
 Lot 7 NE1/4NW1/4, Section 2, T4N, R25E, W.M.;
 South 88 degrees 22 minutes, 46 seconds west, 2829 feet from
 the NE corner, Section 2

Potlatch Corporation
 Hybrid Poplar Program
 T3N R27E Section 18
 Final Proof Map
 Water Rights Transfer Application
 T8618
 From Certificate 74193



RECEIVED
 SEP 30 2005
 WATER RESOURCES DEPT
 SALEM, OREGON

COBU MAP #
 0178
 1 of 4