

TRANSFER APPLICATION MAP IN THE NAME OF
 MT. JEFFERSON FARMS, INC., Walter R. Miller
 T 10 S R 2 W, W.M.

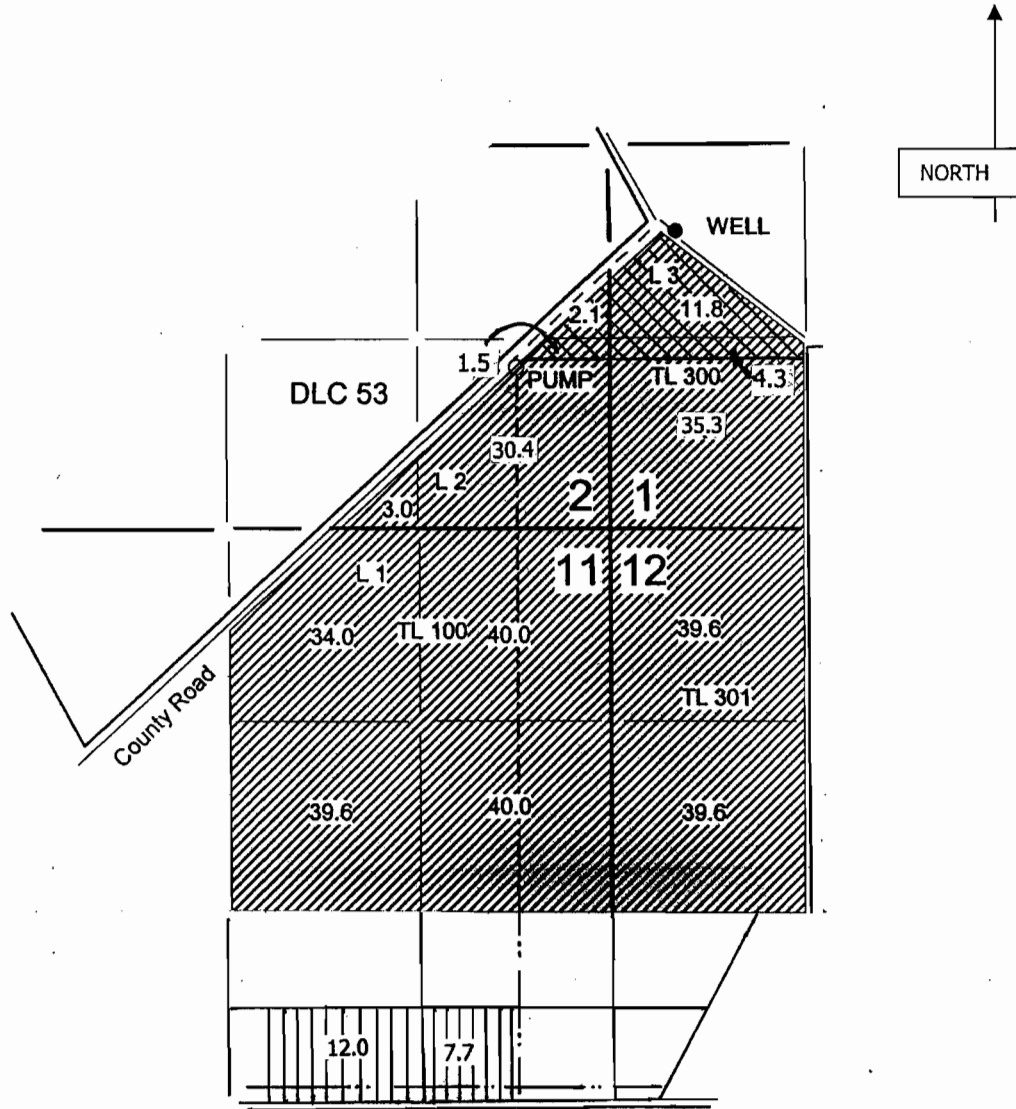

RECEIVED

SEP - 9 2009

WATER RESOURCES DEPT
 SALEM, OREGON



FROM



TO

WELL: 80' S & 160' E from the SE corner DLC 53

Scale 1" = 1320'

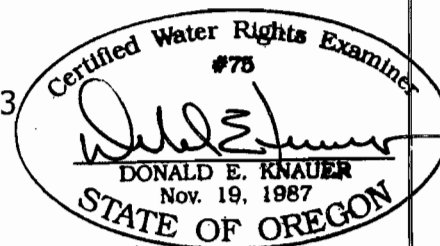

RENEWAL DATE: 6-30-2011

This map is for water
 right purposes only.