

T.4S., R.3W., W.M.

LOTS ANNOTATED ON MAP BY WRD STAFF - 8-20-2007 jwg

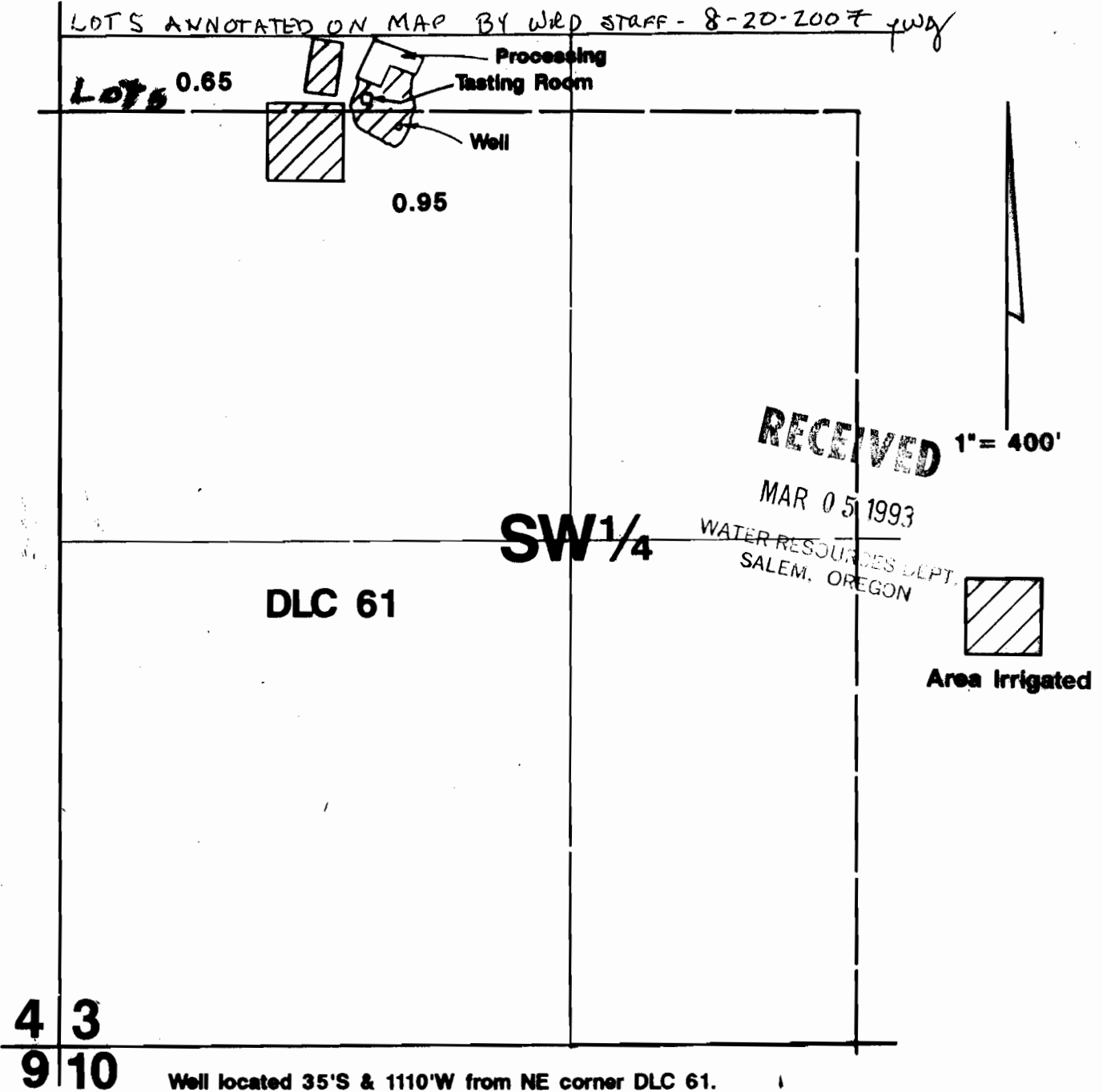

4 3
9 10

Well located 35'S & 1110'W from NE corner DLC 61.

Final Proof Survey

Application #: G-11878 Permit #: G-10895

In Name Of

Sokol Blosser Winery

Surveyed by JM Schuette on August 19, 1992

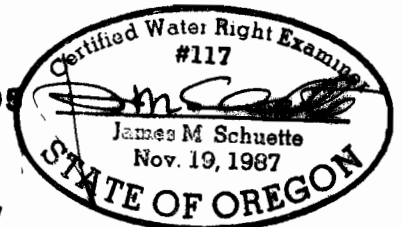

THIS MAP WAS PREPARED FOR THE PURPOSE OF IDENTIFYING THE LOCATION OF A WATER RIGHT ONLY AND IS NOT INTENDED TO PROVIDE LEGAL DIMENSIONS OR LOCATION OF PROPERTY