

T1N, R23E, WM

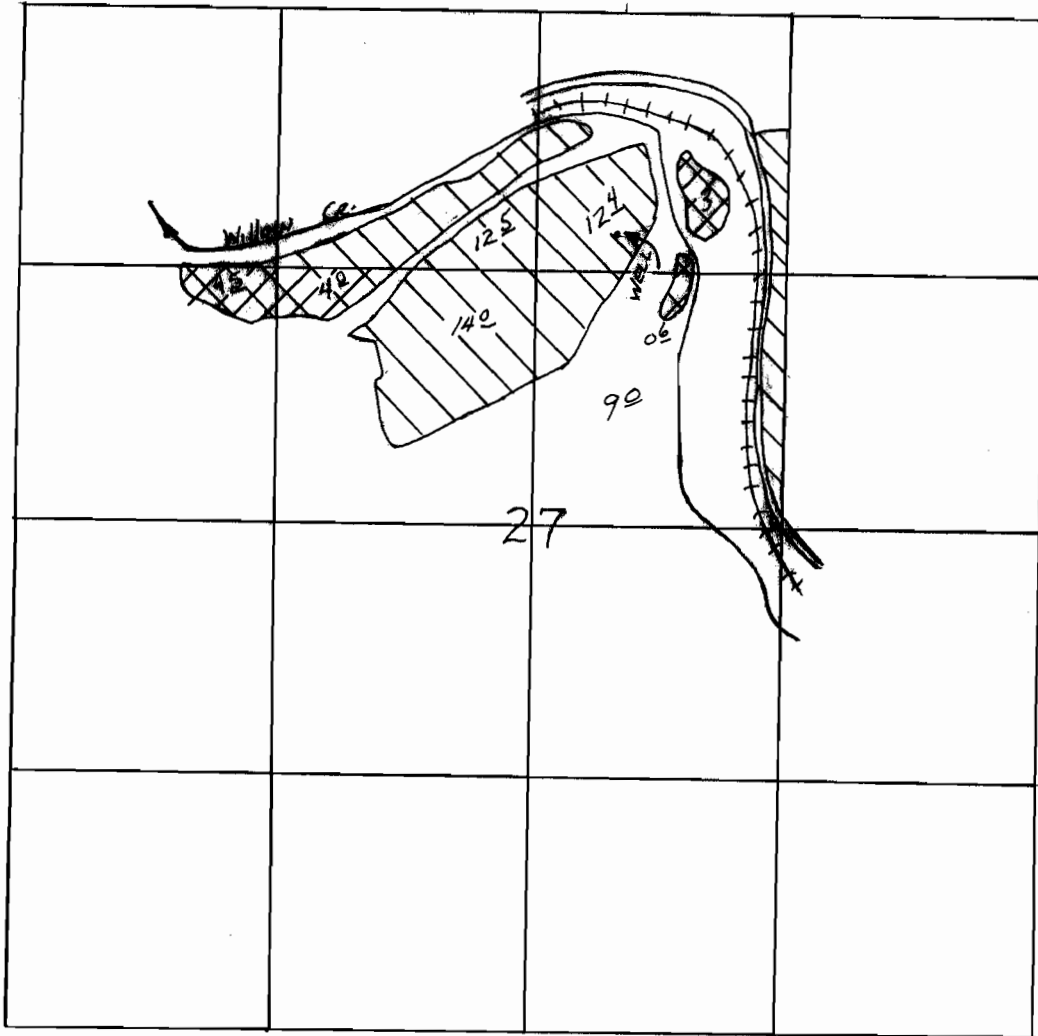

WELL LOC: 1120'S & 2180' W FROM NE COR SEC. 27

THIS MAP PREPARED BY:

J. Deun



SCALE 1" = 1000'

FROM INFORMATION FURNISHED BY THE APPLICANT.

APPLICATION MAP

~~FINAL PROOF SURVEY~~

UNDER

 SUPPLEMENTAL
 PRIMARY

Application No. Permit No.
IN NAME OF

.....

Surveyed 19....., by

Application No. G-8196
Permit No. G 7617

RECEIVED
JUN 7 1977
WATER RESOURCES DIV
SOUTH DAKOTA