

EXHIBET A

RECEIVED

JUN 24 1994

R. RESOURCES, INC.

R. Donald and Betsy B. Allaire
June, 1994

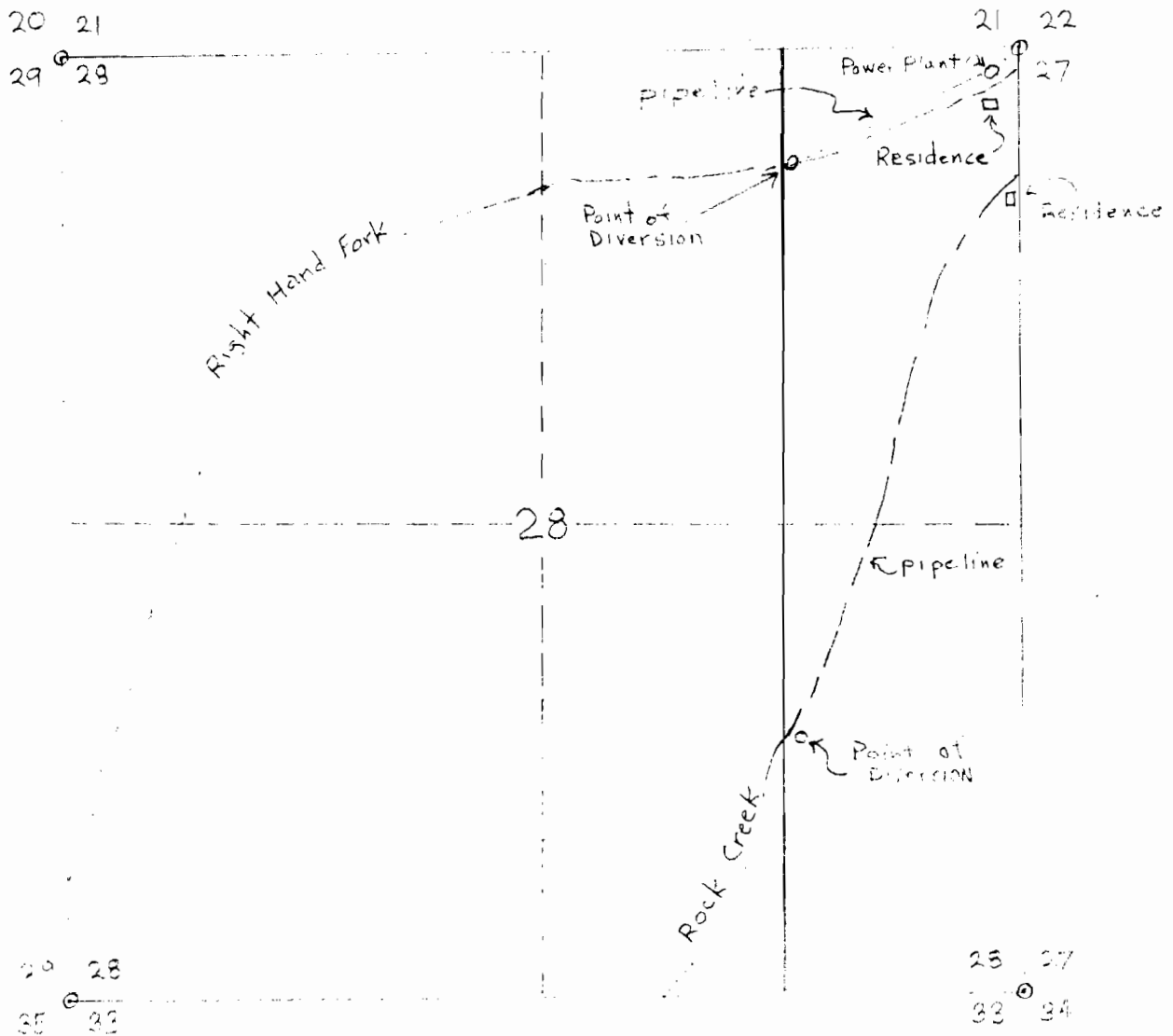

SECTION 28

TOWNSHIP 39 SOUTH, RANGE 5 WEST OF THE
WILLAMETTE MERIDIAN, JOSEPHINE COUNTY, OREGON

Scale 1" = 1,000'

