

T. 3N., R. 28E., W.M.

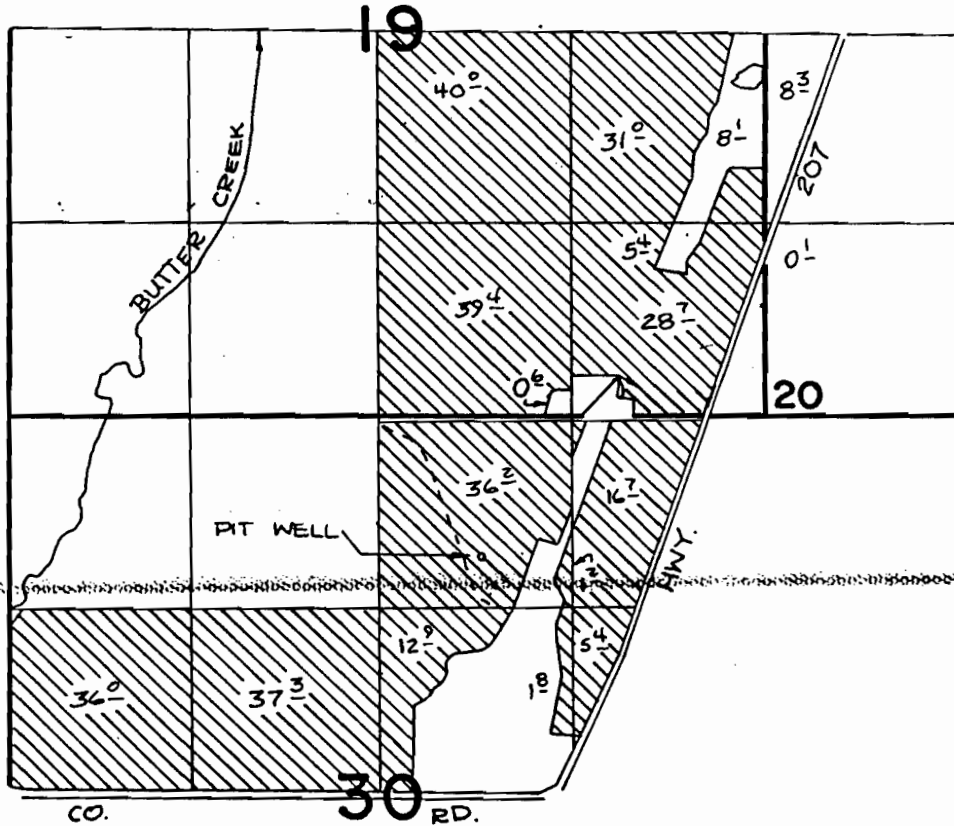

PIT WELL IS LOCATED 970' S. AND 1950' W. FROM THE NE. CORNER OF SECTION 30.

SCALE 1" = 1320'

**FINAL PROOF SURVEY**  
UNDER

G-8167                      G-7207  
Application No. G-8213    Permit No. G-7615.....  
IN NAME OF

.....MADISON..... RANCHES,..... INC.....

Surveyed MAY 15, 1983, by *Steven D. Applegate*