

T. 3N., R. 28E., W.M.

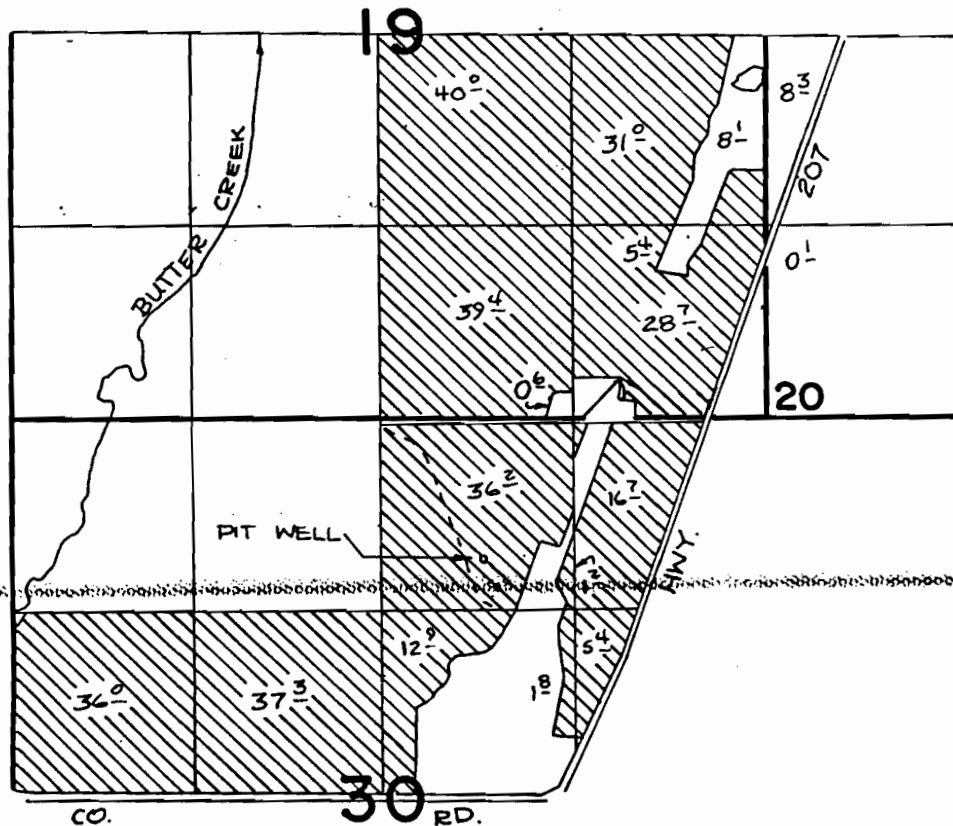

PIT WELL IS LOCATED 970' S. AND 1950' W. FROM THE NE. CORNER OF SECTION 30.

SCALE 1" = 1320'

**FINAL PROOF SURVEY**  
UNDER

G-8167                      G-7207  
Application No. **G-8213** Permit No. **G-7615**.....  
IN NAME OF

.....**MADISON RANCHES, INC.**.....

Surveyed MAY 15, 1983, by *Steven D. Applegate*