

# CLAIM OF BENEFICIAL USE MAP

UNDER APPLICATION R-85147 ; PERMIT R-13480

SW1/4 NW1/4 SEC 35 T 27S R 44E W.M.

U.S.G.S. QUAD - MCCAIN CREEK, OREG. - 7 1/2'

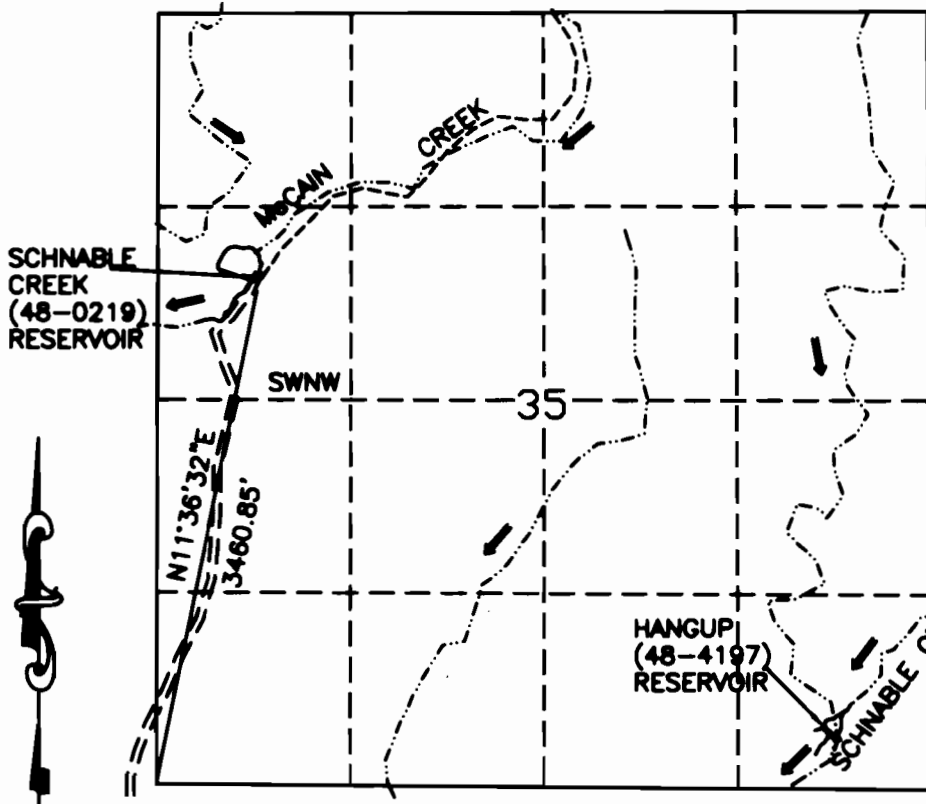

- LEGEND**
- RESERVOIR
  - ROAD
  - CHANNEL
  - FD SEC COR
  - RESERVOIR (NOT ON QUAD)

**RECEIVED**

SEP 10 2007

WATER SOURCES DEPT  
SALEM OREGON

## SCHNABLE CREEK (48-0219) RESERVOIR

ASSESSOR MAP 27S44E  
TAX LOT 200

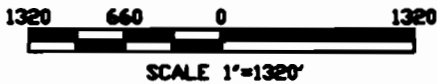

I, Charles E. Joy, Administrative Officer, Vale BLM agree to the findings of the CWRE and do submit this site report and map as my Claim of Beneficial Use of the water as provided under the terms and conditions of my Permit R-13480

*Charles E. Joy*



THIS MAP IS FOR THE PURPOSE OF LOCATING A WATER RIGHT AND IS NOT INTENDED TO PROVIDE LEGAL DIMENSIONS FOR LOCATION OF PROPERTY BOUNDARIES.

ACADSWG DVG FILE SCHNABLE-BEN

UNITED STATES DEPARTMENT OF THE INTERIOR BUREAU OF LAND MANAGEMENT DIVISION OF OPERATIONS VALE DISTRICT	
SCHNABLE CREEK (48-0219) RESERVOIR	
DESIGNED: <i>Theresa J. ...</i>	
REVIEWED: <i>Theresa J. ...</i>	
APPROVED: <i>Charles E. Joy</i>	ADMINISTRATIVE AND FIELD SERVICES
DRAWN: CG	SCALE: 1"=1320'
DATE: 11/22/06	SHEET 1 OF 1
DRAWING NO. OR-03-9172.45-1283	