

T.8S., R.2W., W.M.

RECEIVED

JUN 30 1997

WATER RESOURCES DEPT
SALEM, OREGON

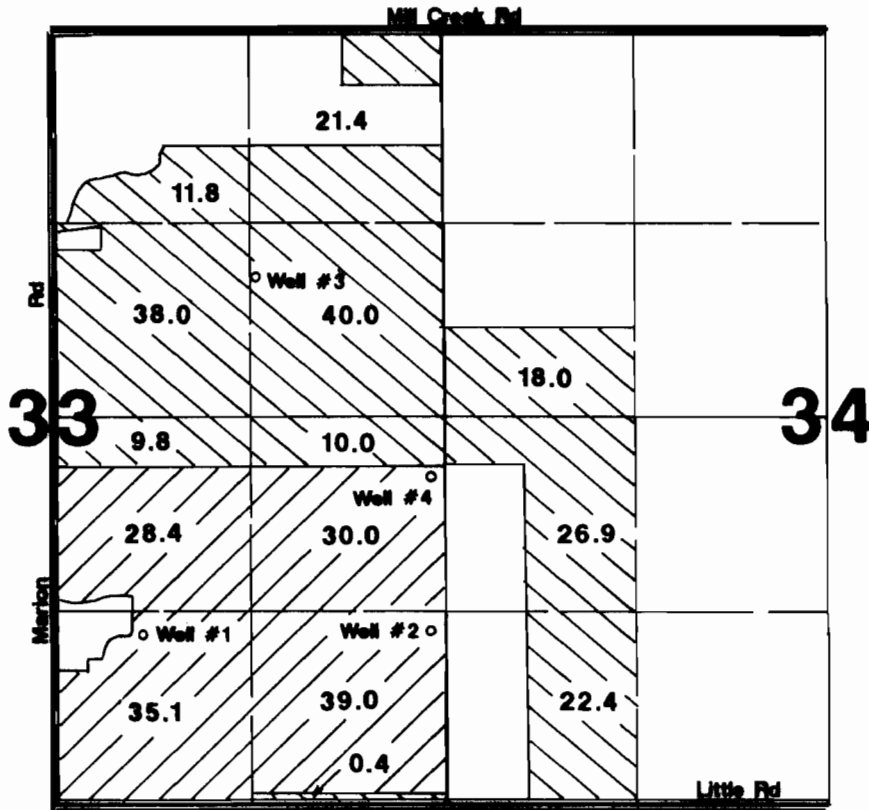

1" = 1320'

Area Irrigated



Well #4-Primary



Well #4-Supplemental

Well #4 located 380'S & 2590'E of center Section 33.

Final Proof Survey

Transfer #: T-6546

In Name Of

Donald J. Etzel

Surveyed on June 10, 1997 by JM Schuette

THIS MAP WAS PREPARED FOR THE PURPOSE OF IDENTIFYING THE LOCATION OF A WATER RIGHT ONLY AND IS NOT INTENDED TO PROVIDE LEGAL DIMENSIONS OR LOCATION OF PROPERTY OWNERSHIP LINES.

