

RECEIVED

APR 16 1993

WATER RESOURCES DEPT.  
SALEM, OREGON

# T. 2N., R. 31E., W.M.

## UMATILLA COUNTY

Well Loc. 200' North & 1950' East of West 1/4 of Section 16  
POD # 1 - S 68°19' E 2011.8' from W 1/4 Corner of Section 16  
POD # 2 - S 49°20' E 1145.0' from W 1/4 Corner of Section 16

Permit # G-11435  
Transfer # T-63668

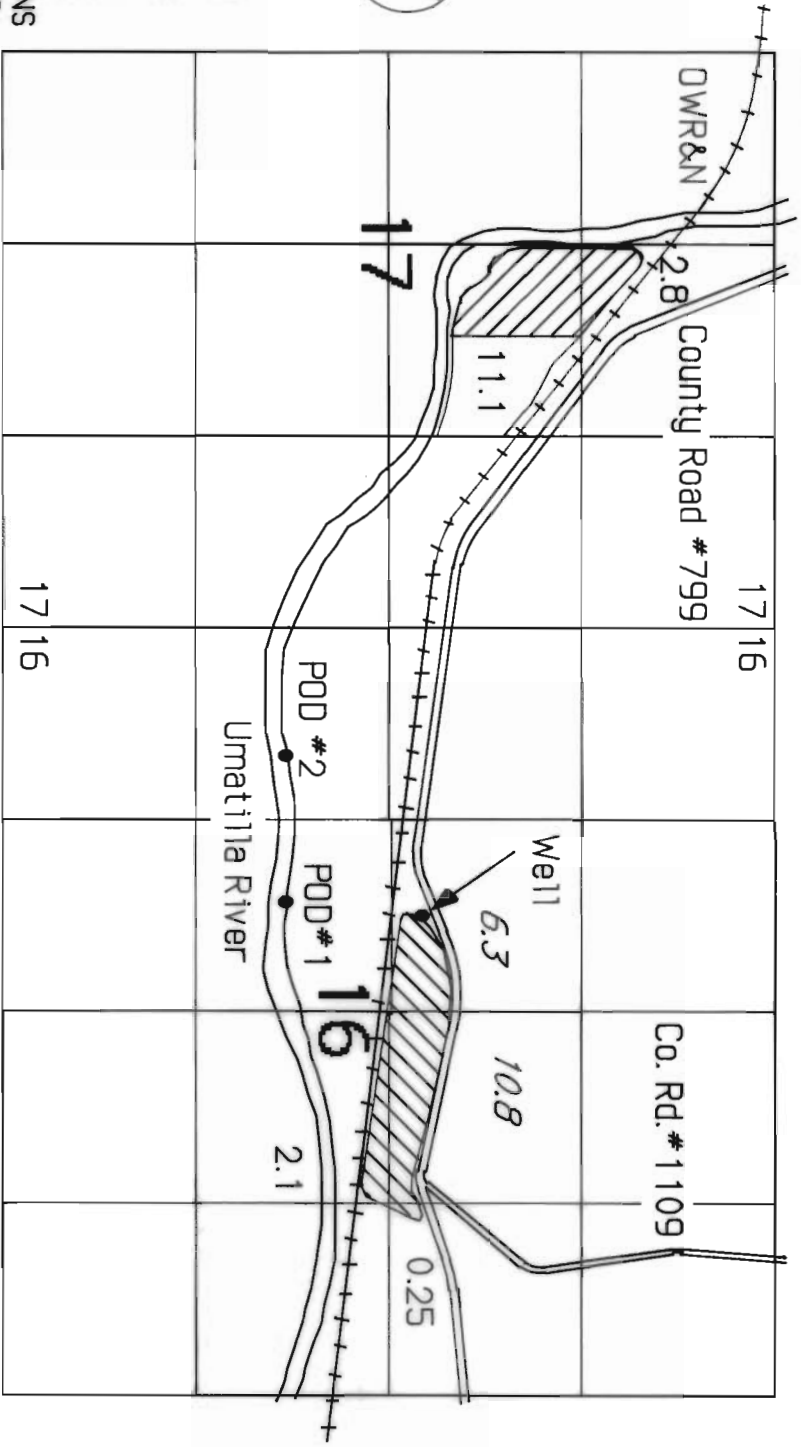

THIS MAP IS FOR THE PURPOSE OF IDENTIFYING THE LOCATION OF WATER RIGHTS ONLY AND IS NOT INTENDED TO PROVIDE THE LEGAL DIMENSIONS OR LOCATIONS OF PROPERTY OWNERSHIP LINES.

WATER RIGHTS PROOF MAP

IN NAME OF

*Dean Forth*



SCALE 1" = 1320'

ENGINEERING - SURVEYING - WATER RIGHTS  
**R V MCKINNIS ENGINEERING**  
Rt 1 Box 1122 Hermiston, Oregon 97838  
503-567-2017

1945