

T13S, R29E, W.M.

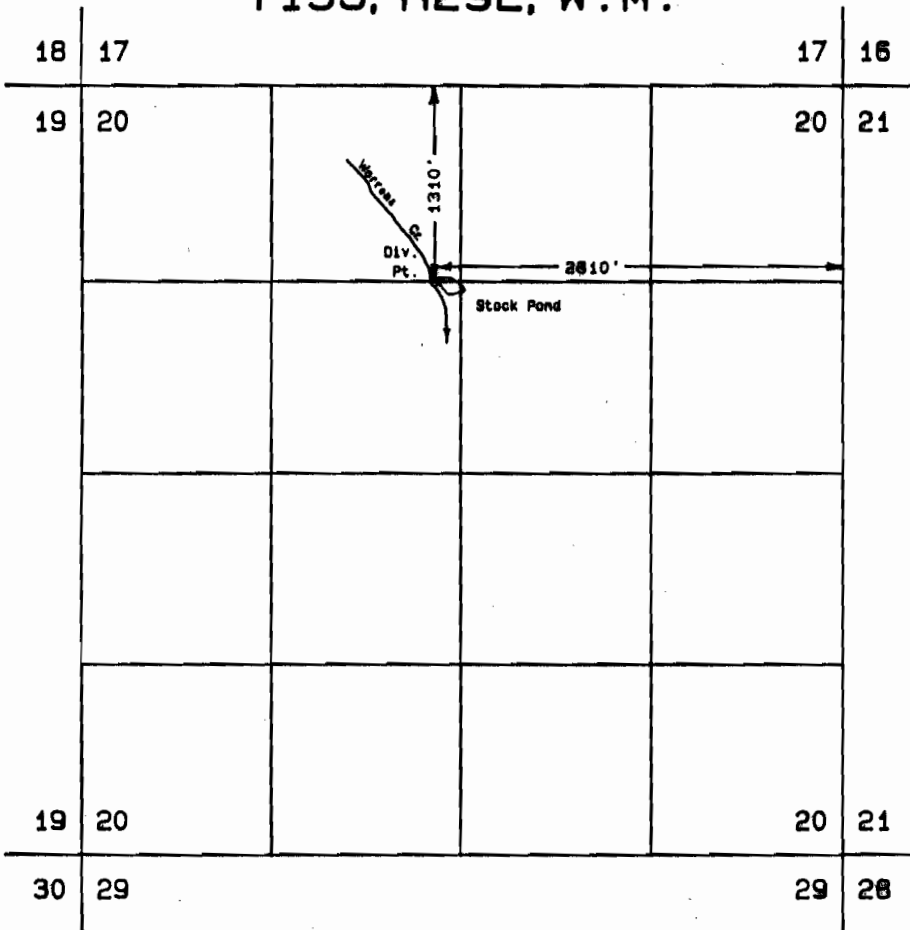

SCALE 1"=1320'

FINAL PROOF SURVEY
UNDER

PERMIT NO. R-11445

IN NAME OF
WILLIAM CHARLES TOOP

Surveyed March 2, 1993

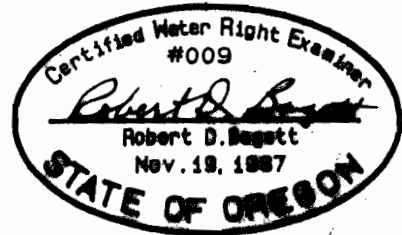

NOTE: The preparation of this map was for the purpose of identifying the location of the proposed water right and has no intent to provide dimensions or location of property ownership lines.