

T. 1 N., R. 4 W., W. M.

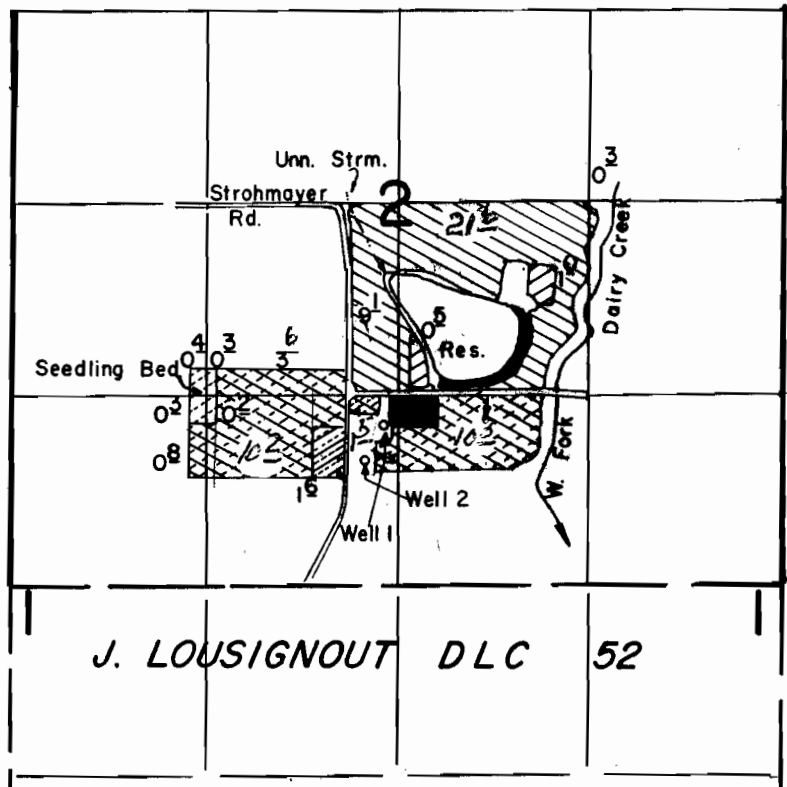

J. LOUSIGNOUT DLC 52

Well 1 Loc. : 1100' N. & 2550' E.
 Well 2 Loc. : 850' N. & 2430' E., both from SW Cor. Sec. 2.
 P.O.D. Loc. : 1450' N. & 3300' E. from SW Cor. Sec. 2.

Scale: 1" = 1320'

FINAL PROOF SURVEY UNDER

G-11327 G-10474
 Application No. 68284 Permit No. 49250
 IN NAME OF

NORTHWEST FARM CREDIT SERVICES

Surveyed AUG. 30 1988, by T. Warren

AMENDED
 4/17/07 LHM
 4/067-178-50 B
 1/9/09 TW