

Sec. 11, T. 33 S., R 2 E., W. M

Nye Ditch Div. Pt
 1860 N & 2690 E
 from SW Cor. S. 28
 T. 32 S., R. 3 E., W. M.

RECEIVED

AUG 12 1994

WATER RESOURCES DEPT.
 SALEM, OREGON

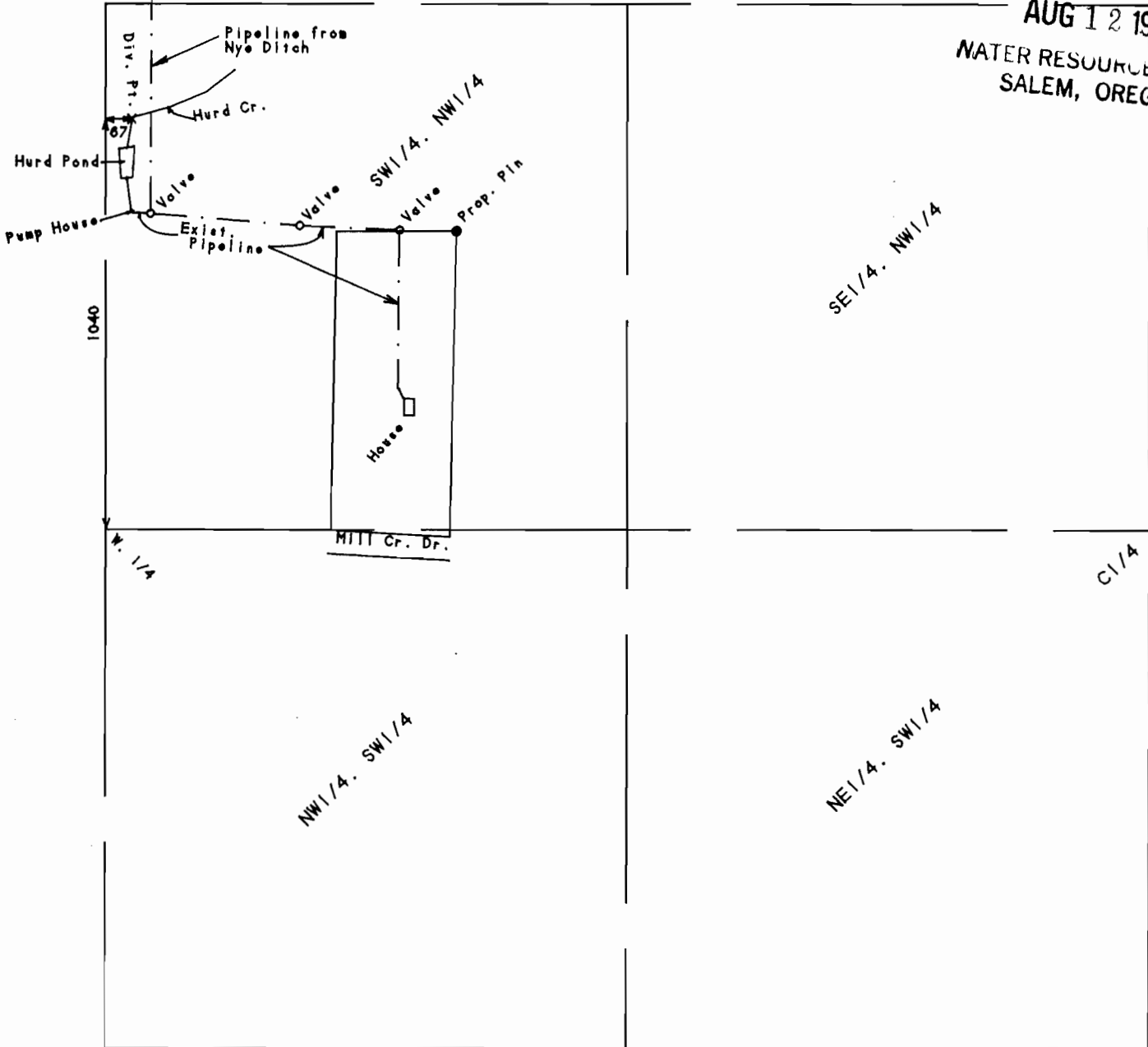

FINAL PROOF MAP
 Application No. 70842. Permit No. 51506.
 in name of
 JAMES V. & POLLY L. DEVORE
 Mapped July 28, 1994 Scale 1" = 400'
 Mapped by: L.J. Friar & Associates P.C.
 Consulting Land Surveyors
 304 South Holly Street
 Medford, OR 97501
 (503) 772-2782

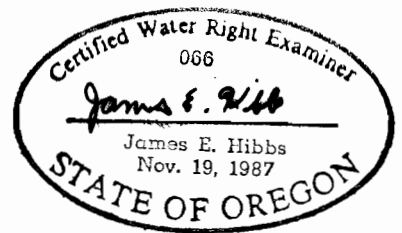

THE PREPARATION OF THIS MAP WAS FOR THE PURPOSE OF IDENTIFYING THE WATER RIGHT & HAS NO INTENT TO PROVIDE DIMENSION OR LOCATION OF PROPERTY OWNERSHIP LINES.