

# T.6S., R.2W., W.M.

SEP 20 1994

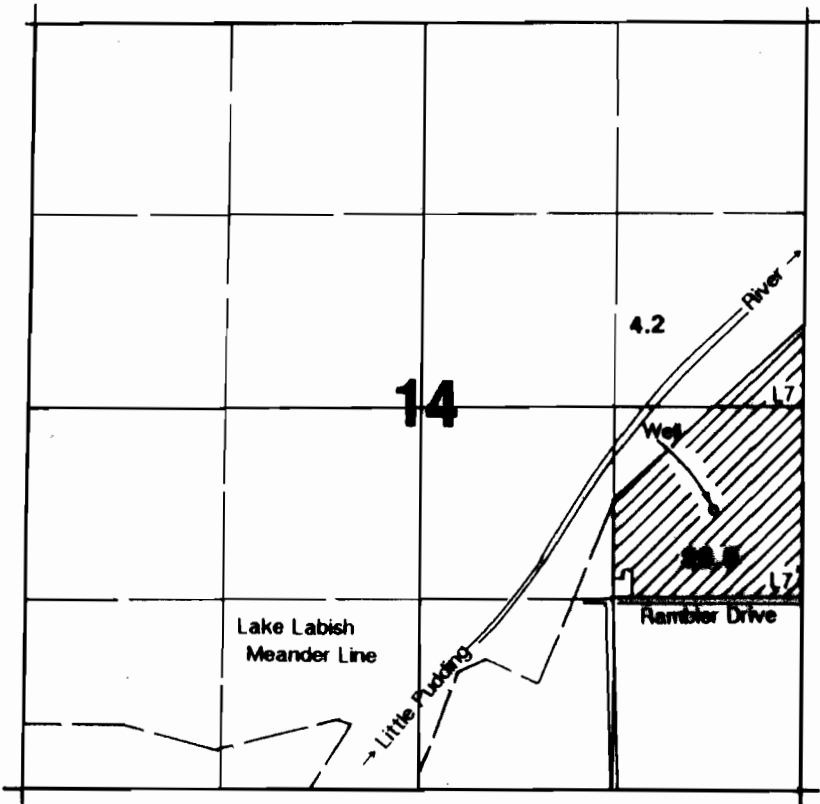

1" = 1320'

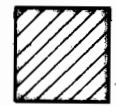

Area Irrigated

Well located 1940'<sup>W</sup>N & 600'<sup>E</sup> from SE corner Section 14.

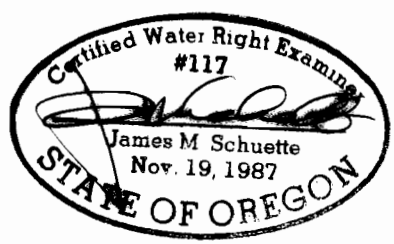

## Final Proof Survey

Application #: G-12239 Permit #: G-11147

In Name Of

# Wilbur A. Klopfenstein

Surveyed on September 7, 1994 by JM Schuette

THIS MAP WAS PREPARED FOR THE PURPOSE OF IDENTIFYING THE LOCATION OF A WATER RIGHT ONLY AND IS NOT INTENDED TO PROVIDE LEGAL DIMENSIONS OR LOCATION OF PROPERTY OWNERSHIP LINES.

AMENDED BY WRD STAFF, 4/1/08 JWG