

# BENEFICIAL USE MAP

APPLICATION R-71491  
 PERMIT R-11451

IN THE NAME OF:

UNITED STATES BUREAU OF LAND MANAGEMENT

COOS BAY DISTRICT OFFICE  
 1300 AIRPORT LANE  
 NORTH BEND, OR. 97459

T. 21 and 22 S., R. 11 W., W.M.  
 SECTIONS 32, 5, and 6  
 JUNE 7, 1993

WETLAND SURFACE AREA	WATER CONTROL STRUCTURE LOCATION FROM NW CORNER SECTION 5
<b>RESERVOIR "A"</b> Sec. 6 NW1/4 NE1/4 3.39 AC. NE1/4 NE1/4 .36 AC. 3.75 AC.	1083.69 SOUTH, 1274.08 WEST
<b>RESERVOIR "B"</b> Sec. 6 NW1/4 NW1/4 2.70 AC. Sec. 6 NE1/4 NE1/4 .70 AC. 3.40 AC.	603.57 SOUTH, 106.08 EAST
<b>RESERVOIR "C"</b> Sec. 32 SW1/4 SW1/4 3.75 AC. Sec. 5 NW1/4 NW1/4 .43 AC. 4.20 AC.	323.93 NORTH, 942.46 EAST
<b>RESERVOIR "D"</b> Sec. 5 NW1/4 NW1/4 10.29 AC. Sec. 5 NE1/4 NE1/4 6.81 AC. 16.80 AC.	705.69 SOUTH, 120.57 EAST
<b>RESERVOIR "E"</b> Sec. 5 NW1/4 NE1/4 1.00 AC. Sec. 32 SW1/4 SE1/4 .30 AC. 1.80 AC.	252.27 SOUTH, 2871.31 EAST
<b>TOTAL ACREAGE</b>	<b>30.16 AC.</b>

SCALE

1" = 1320'

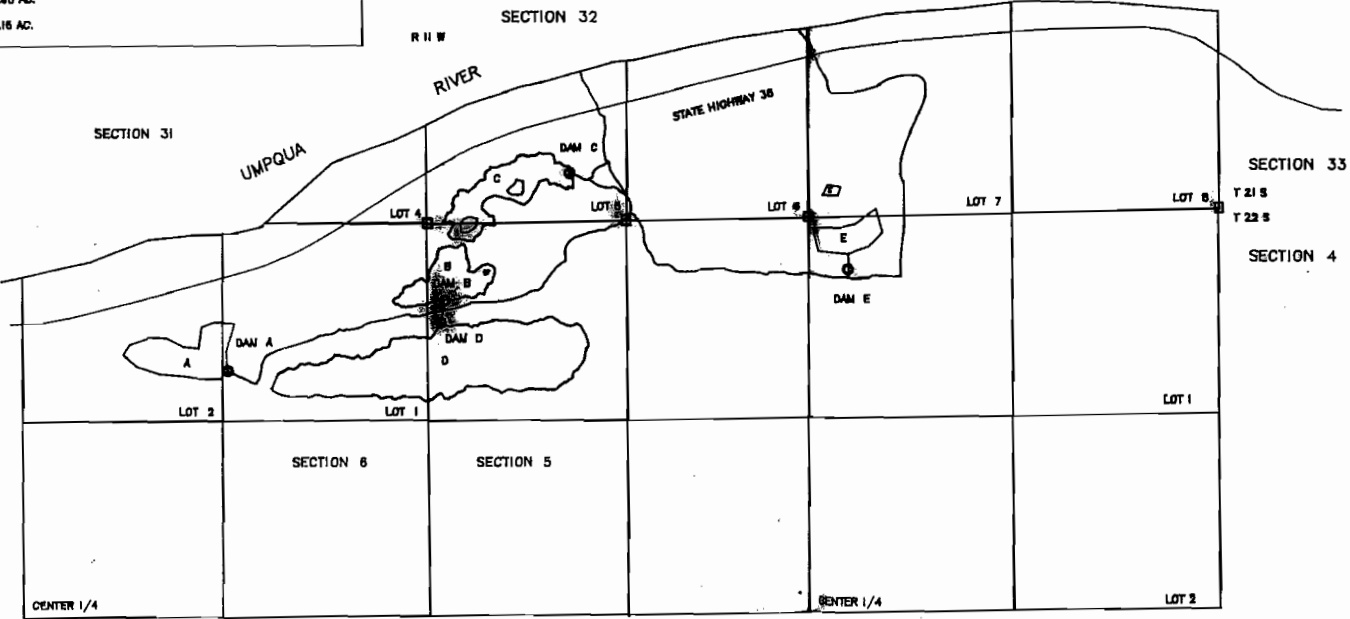

**LEGEND**

- FOUND BEAM BRASS CAP
- WATER CONTROL STRUCTURE
- HIGHWAY

**NOTE:**

THE PURPOSE OF THIS MAP IS TO IDENTIFY THE LOCATION OF THE BRASS CAPS AND TO INTEND TO BE USED TO IDENTIFY THE PROPERTY BOUNDARY LINES.

**EXECUTED BY:**

BOYD W. PETERSON, RLS, CWRE  
 CADASTRAL SURVEYOR  
 BUREAU OF LAND MANAGEMENT  
 COOS BAY DISTRICT OFFICE  
 1300 AIRPORT LANE  
 NORTH BEND, OR. 97459

