

T.4 S. and T.5 S. R.1 W. W.M.

MARION COUNTY, OREGON

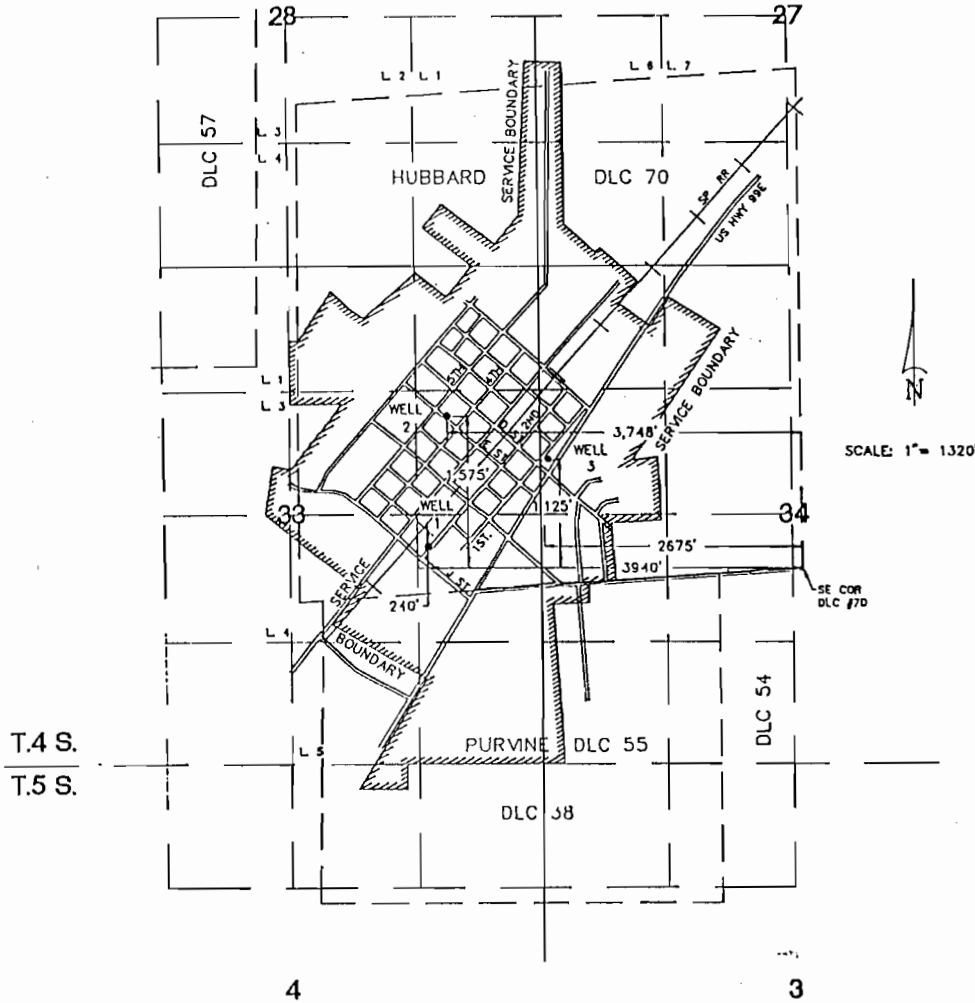

CITY OF HUBBARD

FINAL PROOF SURVEY

THIS MAP WAS PREPARED FOR THE PURPOSE OF IDENTIFYING THE LOCATION OF THE WATER RIGHT ONLY AND HAS NO INTENT TO PROVIDE DIMENSIONS OR LOCATION OF PROPERTY OWNERSHIP LINES.

RECEIVED

DEC 19 1991

WATER RESOURCES DEPT.
SALEM, OREGON



**RUSS FETROW
ENGINEERING, INC.**
890 PROMONTORY PL., SE, SALEM, OR 97302
2535 S. PRAIRIE RD., EUGENE, OR 97402