

T. 6 & 7 S., R. 17 E.  
WASCO COUNTY

SHANIKO

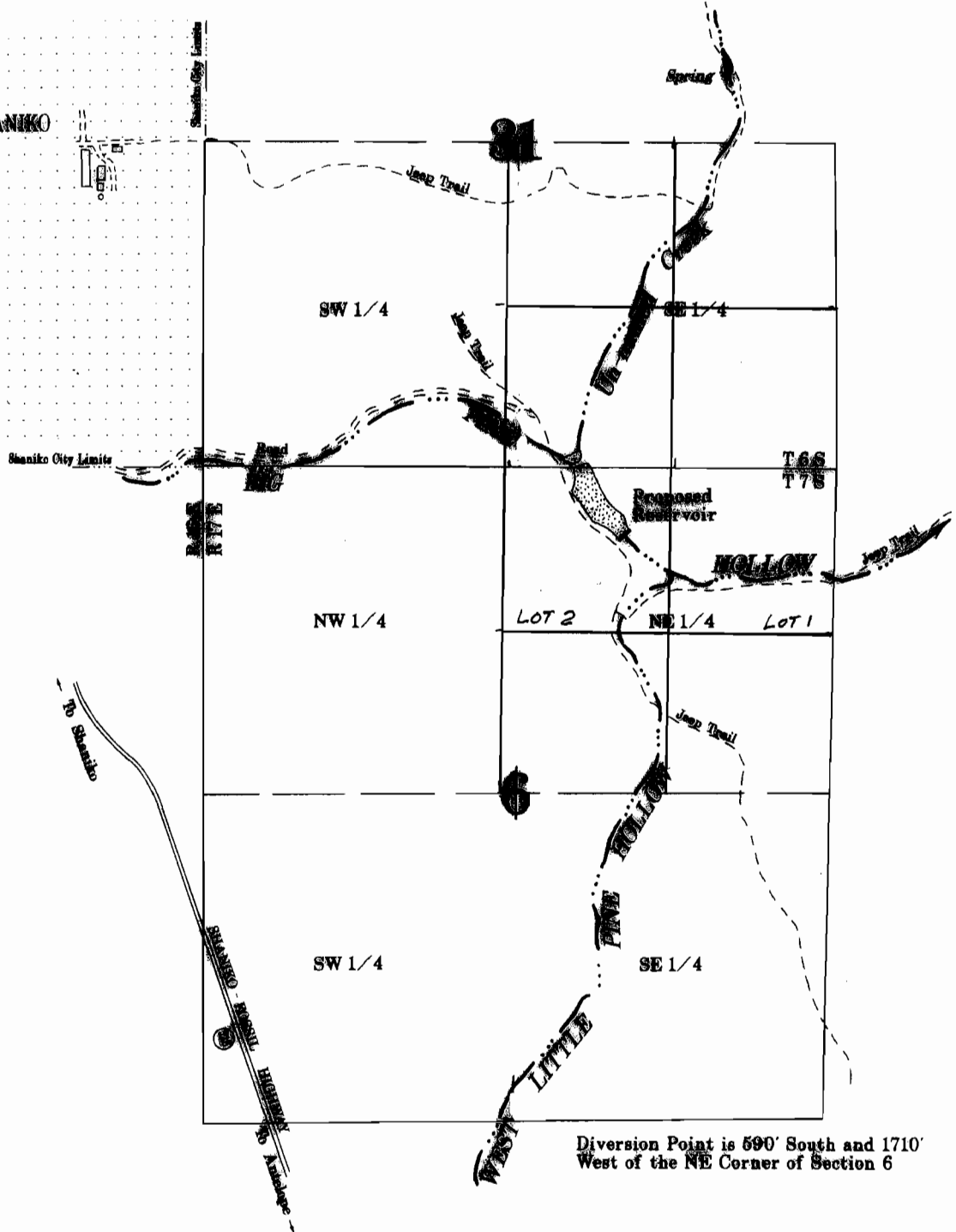

Diversion Point is 590' South and 1710' West of the NE Corner of Section 6

**FINAL PROOF MAP**

RECEIVED

JUN 27 1993

WILLIAM D. GREGG  
SALEM, OREGON

Application No. R - 71751 Permit No. R - 11411

IN THE NAME OF  
**SHANIKO RANCH**

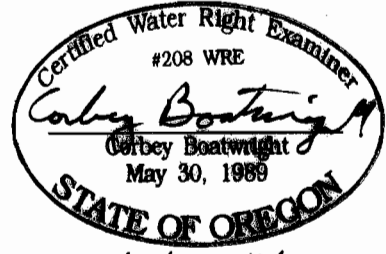

NOTE: This map is for the purpose of identifying the location of water rights and has no intent to dimension or locate property ownership lines.

DATE: June 18, 1993  
SCALE: 1" = 1320'

AMENDED WRD 12/19/07 LHN