

NOTE:
THIS MAP IS FOR THE
PURPOSE OF IDENTIFYING
WATER RIGHTS AND HAS
NO INTENT TO DIMENSION
OR LOCATE PROPERTY
OWNERSHIP LINES.

T.8 S., R.5., W., W.M.
POLK COUNTY, OR.

SEP 29 1994
WATER RIGHTS

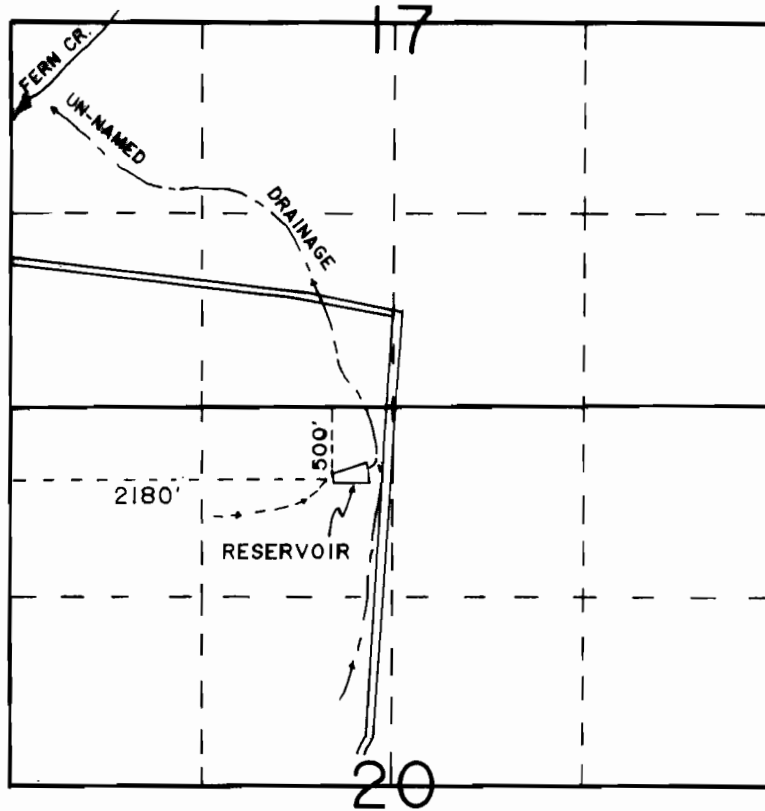

DIVERSION POINT IS 2180' EAST & 500' SOUTH
FROM THE NORTHWEST CORNER OF SECTION 20

FINAL PROOF SURVEY
UNDER

R-70670

R-11263

APPLICATION NO. _____, PERMIT NO. _____

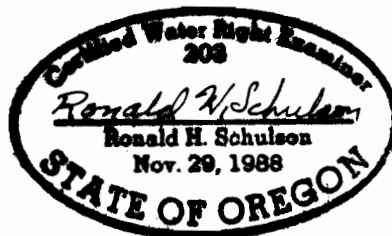

IN THE NAME OF:

JOHN GRAHAM

4515 COOPER HOLLOW RD.
DALLAS, OR 97338
PH. (503)623-6731

SURVEYED SEPT 1994 BY R.H.S.

MAP PREPARED BY:

J & R SURVEYORS

P.O. BOX 418
DALLAS, OR 97338
PH. (503) 623-4003

J & R NO. 94-69-W3