

RECEIVED
 2 2000
 WATER RESOURCES DEPT
 SALEM, OR

T.4S. R.3W. W.M.
 YAMHILL COUNTY

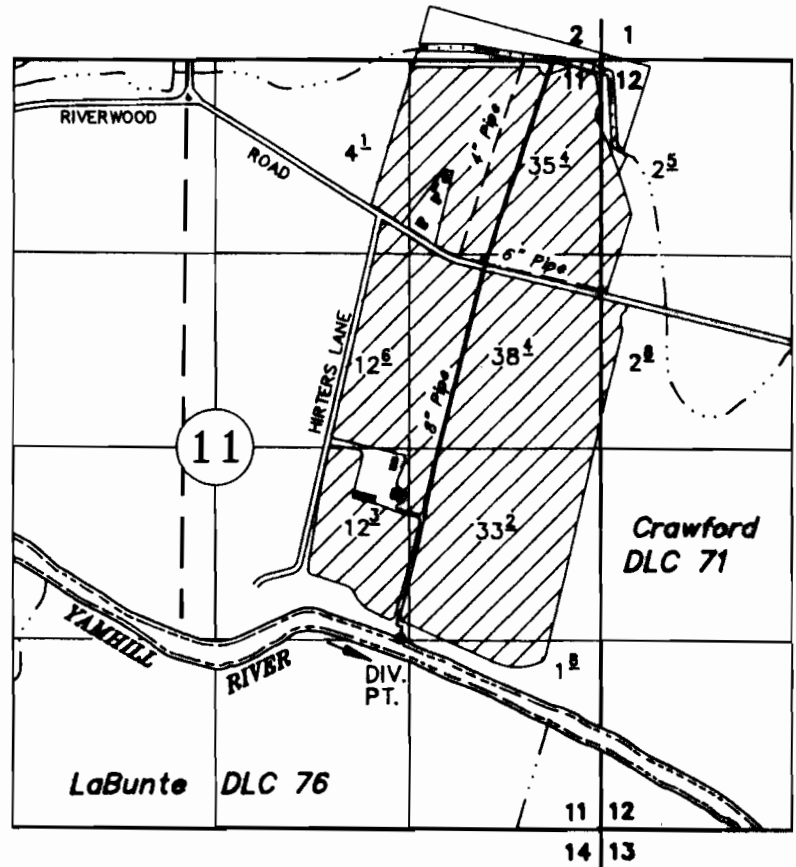

TAX LOTS:
 4 3 11 00300
 4 3 11 00301
 4 3 11 00400

DIV. PT.: 175' S. AND 1500' E. OF THE SW COR OF CRAWFORD DLC 71.

FINAL PROOF SURVEY
 UNDER

18996	14611
50083	37635
52923	39960
Application No. <u>S-72072</u>	Permit No. <u>51965</u>

A & R SPADA FARMS

SEPTEMBER 14, 1999
 SCALE: 1" = 1320'

NOTE: This map is for the purpose of identifying the location of water rights and has no intent to dimension or locate property ownership lines.

