

# T.4S. R.2W. W.M.

MARION COUNTY

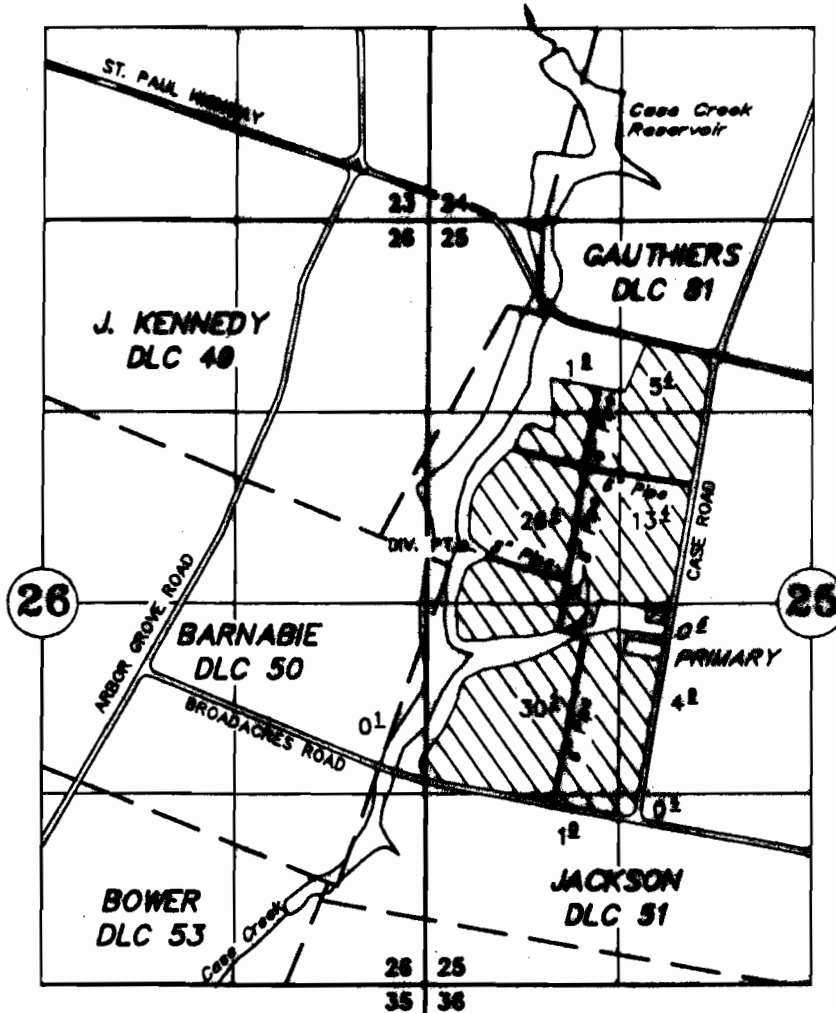
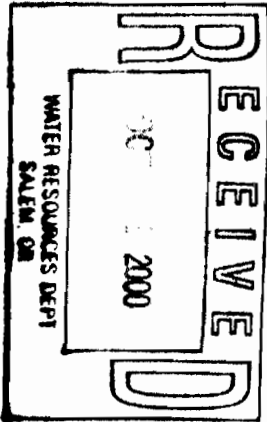

TAX LOT:  
042W25 00600

DIV. PT.: 1660' S. AND 300' W. OF THE NW COR. JACKSON DLC 51.

## FINAL PROOF SURVEY

UNDER



PRIMARY IRRIGATION  
& NURSERY OPERATION



NURSERY OPERATION

Application No.	44948	Permit No.	J4417
	R-44864		R-5480
	40145		28878
	S-72044 ✓		51884

### A & R SPADA FARMS

SEPTEMBER 14, 1999

SCALE: 1" = 1320'

NOTE: This map is for the purpose of identifying the location of water rights and has no intent to dimension or locate property ownership lines.

