

SECTION 12, T. 5 S., R. 5 W., W.M.

1 INCH = 400 FEET

RECEIVED

JUL - 7 1993

WATER RESOURCES DEPT.
SALEM, OREGON

NE 1/4 SE 1/4

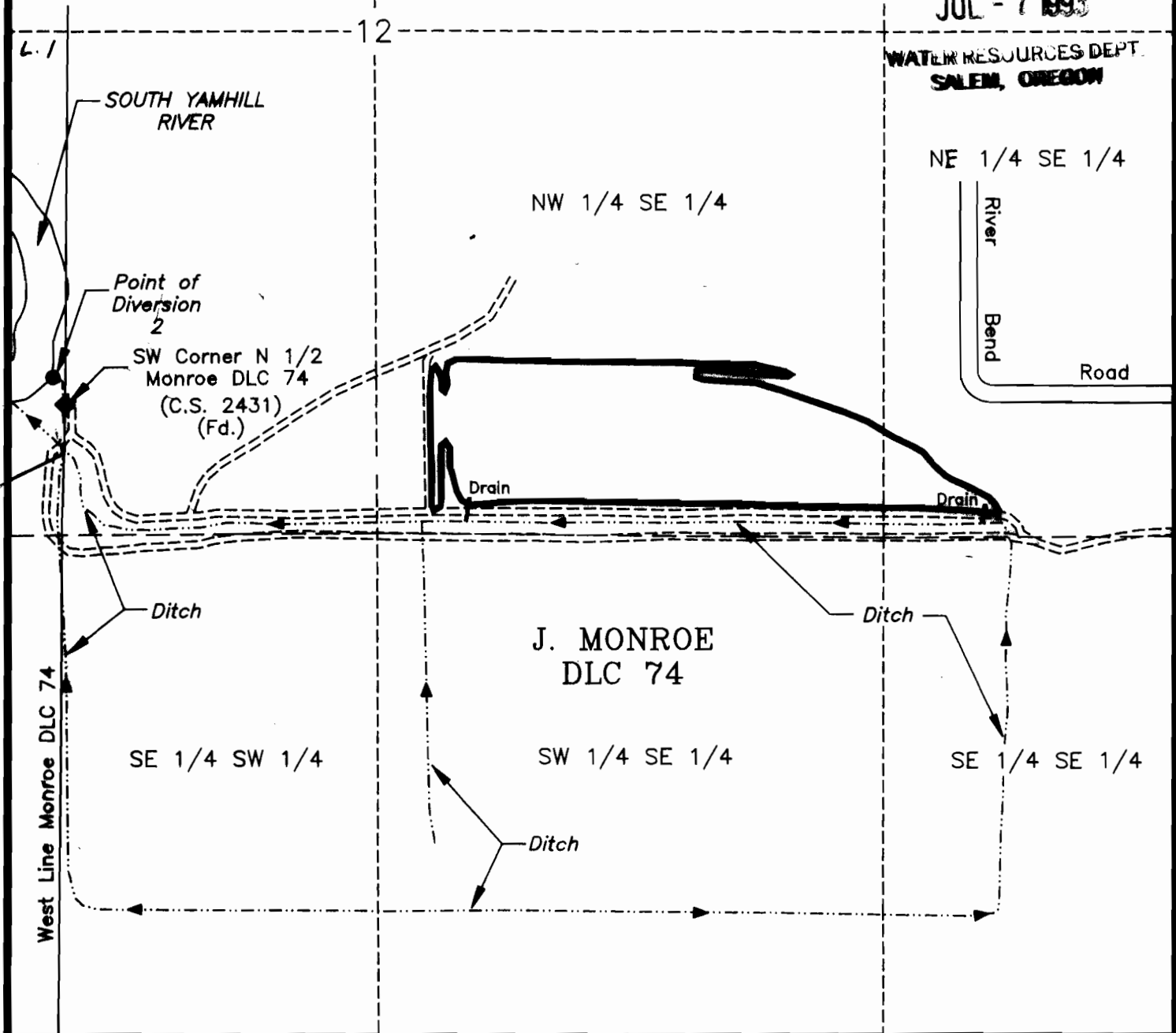
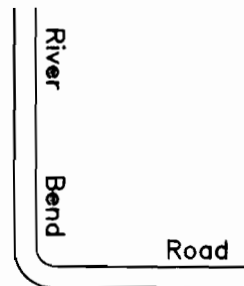

Point of Diversion 2 is North 82 feet and West 31 feet from the Southwest corner of the North One-half Monroe DLC 74

The purpose of this map is to identify the location of the Water Right. It is not intended to provide information relative to the location of Property Ownership Boundary Lines.

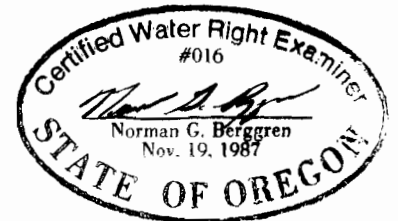

FINAL PROOF SURVEY
UNDER

IN THE NAME OF: STEVEN E. RICE

70675 + 70676



SURVEYED: June 4, 1993 BY: Norman G. Berggren

AMENDED WRD 2/4/08 LHN