

T.33S., R.1W., W.M.

26 | 25

35 | 36

25

36

NW 1/4 NW 1/4

NE 1/4 NW 1/4

SW 1/4 NW 1/4

SE 1/4 NW 1/4

2403'

SOUTH

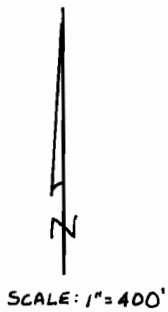
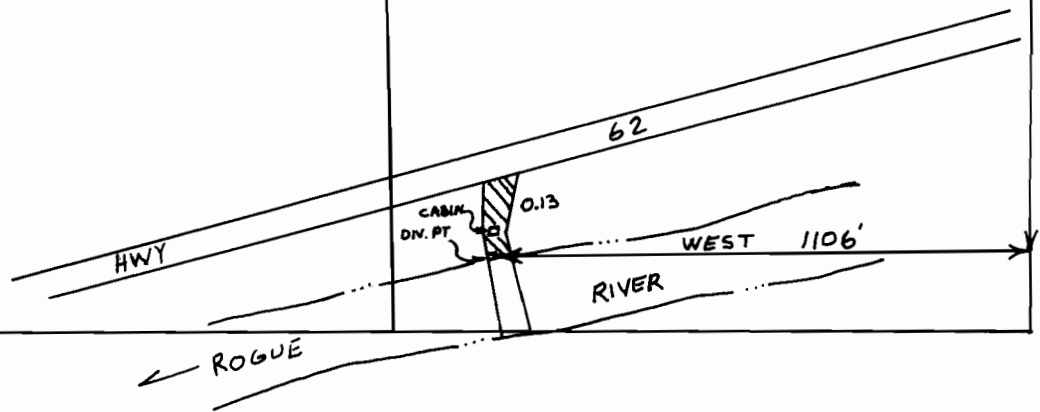

FINAL PROOF MAP
 UNDER
 APP. # 70466 PERMIT # 51321
 IN NAME OF
 RON & ANN BENNETT
 MAPPED: OCT. 26, 1993
 BY: L.J. FRIAR & ASSOC. P.C.
 304 S. HOLLY ST.
 MEDFORD, OR 97501
 (503) 772-2782

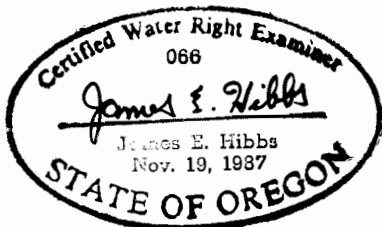

THE PREPARATION OF THIS MAP WAS FOR THE PURPOSE OF IDENTIFYING THE WATER RIGHT ONLY & HAS NO INTENT TO PROVIDE DIMENSION OR LOCATION OF PROPERTY OWNERSHIP LINES.