

10031

See Map filed with App. # 218
Permit # E. 15 for remainder of Lands.

STATE ENGINEER
RECEIVED

MAR 12 1925

SALEM, OREGON

Application No. 10031
Permit No. 6686

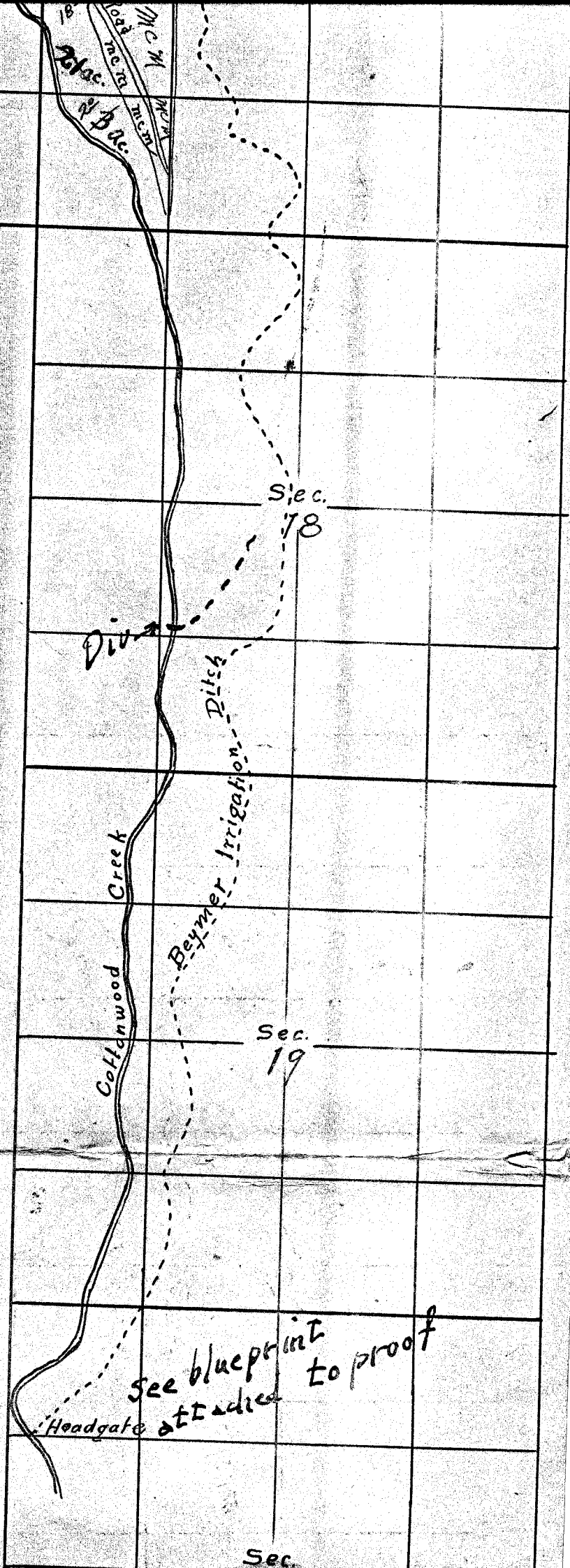

see blueprint attached to proof
Headgate

Sec.

See ~~7~~ E-15
Per 6686
8419

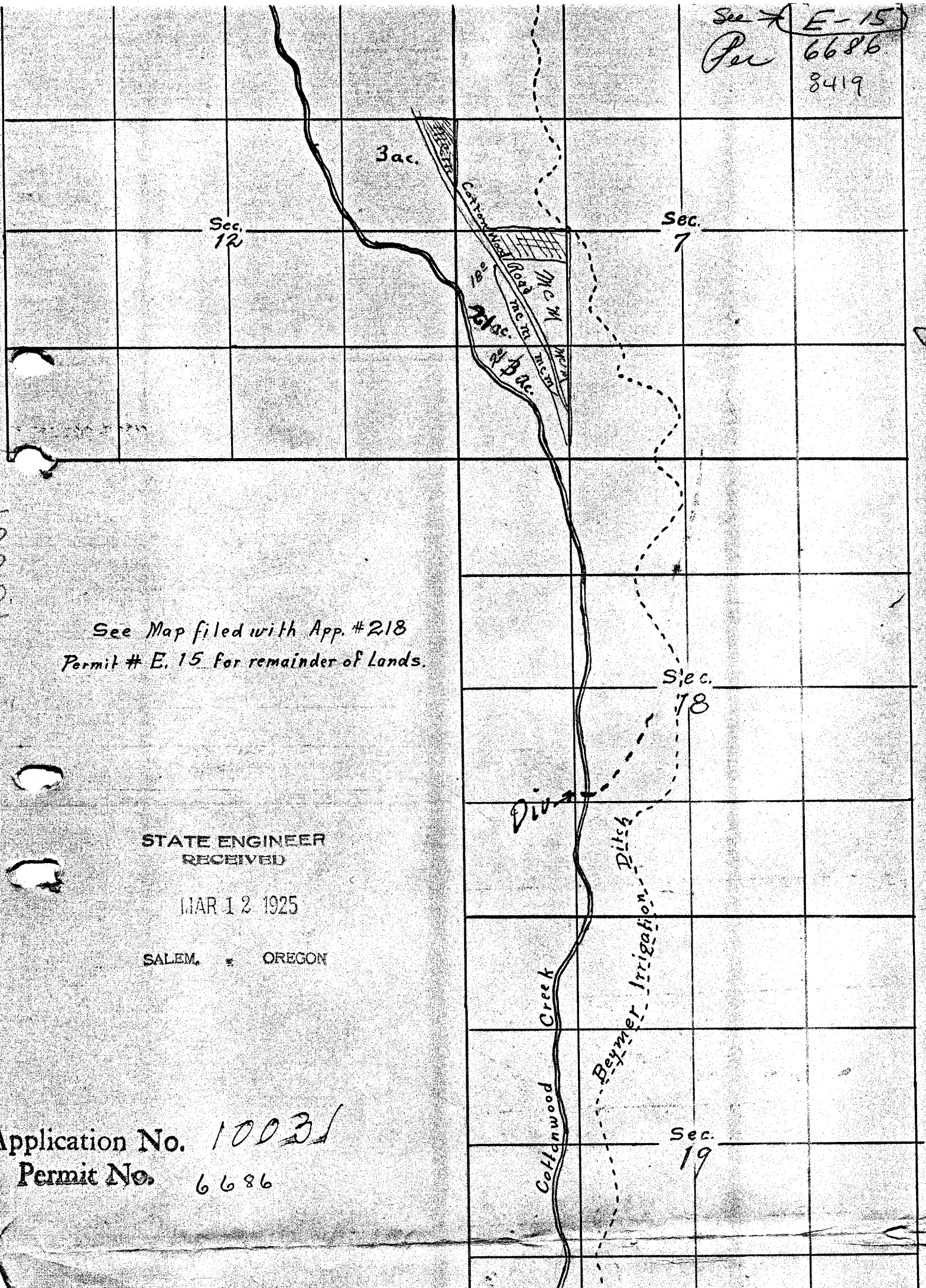

10031

See Map filed with App. #218
Permit # E. 15 for remainder of Lands.

STATE ENGINEER
RECEIVED

MAR 12 1925

SALEM, OREGON

Application No. 10031
Permit No. 6686

Sec. 12
Sec. 7
Sec. 18
Sec. 19
Cottonwood Creek
Beymer Irrigation Ditch
Ditch