

T.4S., R.1W., W.M.

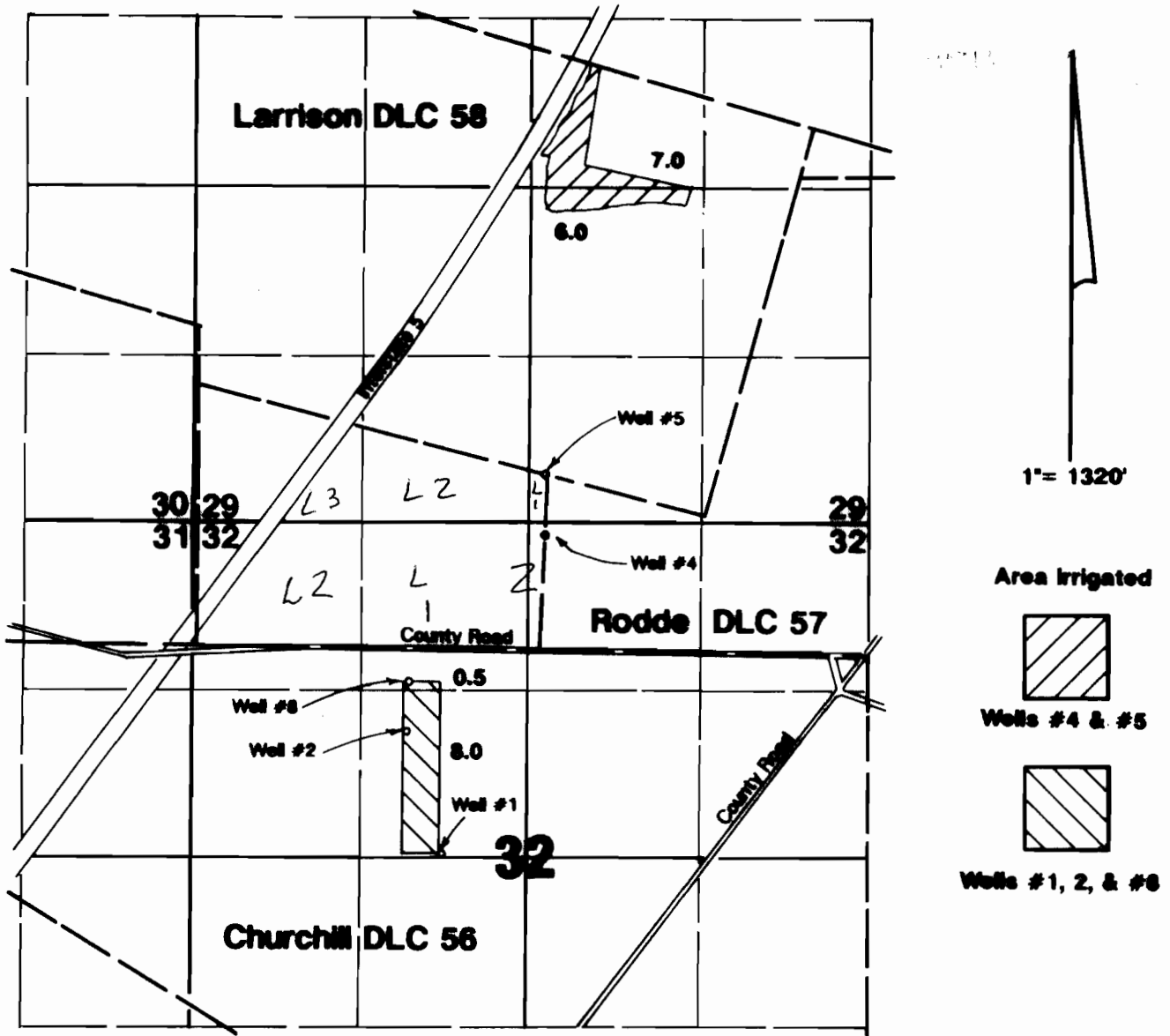

- Well #1 located 60'N & 1950'E from W¼ corner Section 32.
- Well #2 located 980'N & 1650'E from W¼ corner Section 32.
- Well #4 located 70'S & 2750'E from NW corner Section 32.
- Well #5 located 370'N & 2750'E from NW corner Section 32.
- Well #6 located 1380'N & 920'W from center Section 32.

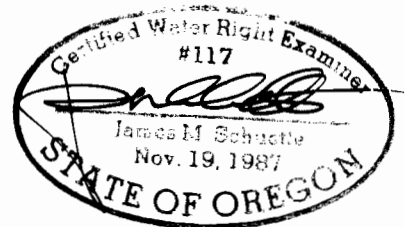

Final Proof Survey

Application #G-12275 Permit #G-11355

In Name Of

Tom DeArmond

Surveyed on October 6, 1994 by J.M. Schuetz

*Amended to reflect Gov Lots by
WRD Staff, 4-25-08, gwg*

**DEPARTMENT OF AGRICULTURE
STATE OF OREGON**