

MAP SHOWING LAND TO BE IRRIGATED

BY MR. K.G. WARNER BY PUMPING.

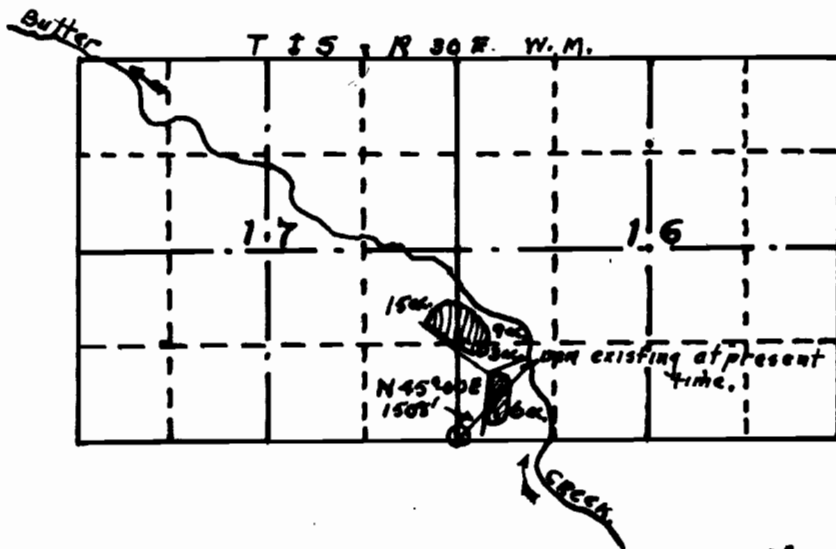

I, Aubrey E. Perry, do hereby certify that this map was made from notes taken during an actual survey on June 27-1918 and shows the existing dam and the land to be irrigated by pumping from said dam.

Aubrey E. Perry.  
Surveyor.

OFFICE OF STATE ENGINEER

RECEIVED

JUL 30 1918

SALEM, OREGON

Application No. 6223  
Permit No. 3877