

T.3S., R.1W., W.M.

RECEIVED

MAY 4 1994

WATER RESOURCES DEPT.
SALEM, OREGON

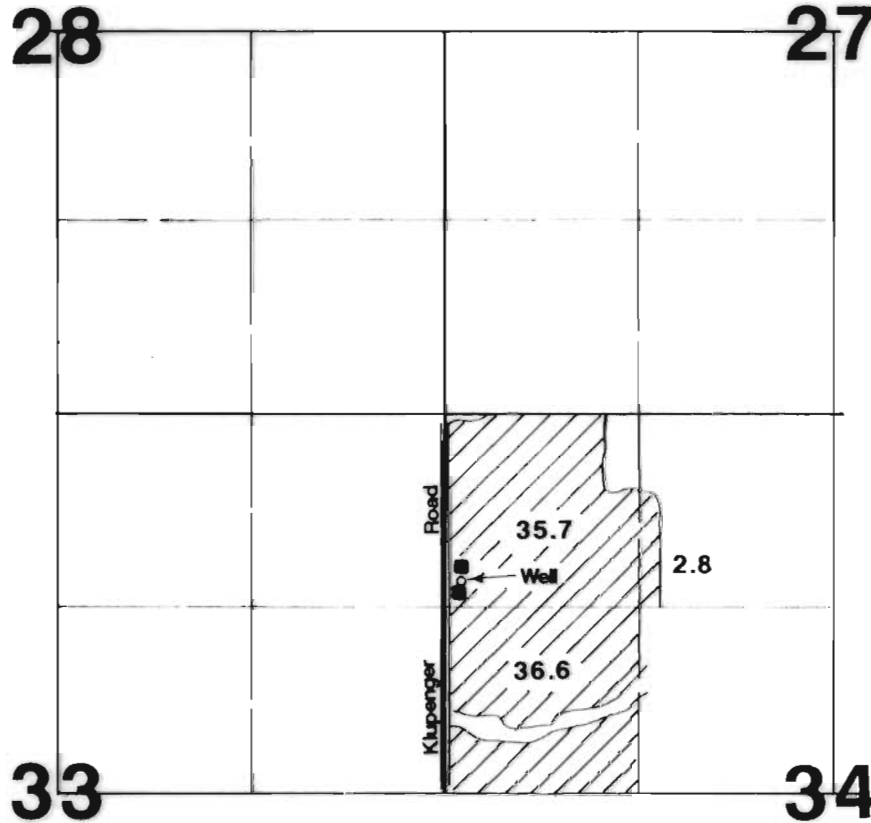

1" = 1320'

Nursery Operations

Well located 147'N & 132'E from NW corner SW¼ NW¼, Section 34.

Final Proof Survey

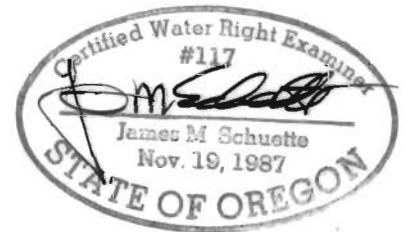

Application #: G-11638

Permit #: G-10852

In Name Of

Klupengers Nursery & GHSE, Inc.

Surveyed on March 26, 1994 by JM Schuette

THIS MAP WAS PREPARED FOR THE PURPOSE OF IDENTIFYING THE LOCATION OF A WATER RIGHT ONLY AND IS NOT INTENDED TO PROVIDE LEGAL DIMENSIONS OR LOCATION OF PROPERTY OWNERSHIP LINES.