

T.1N. R.32E. W.M.

SECTION 30

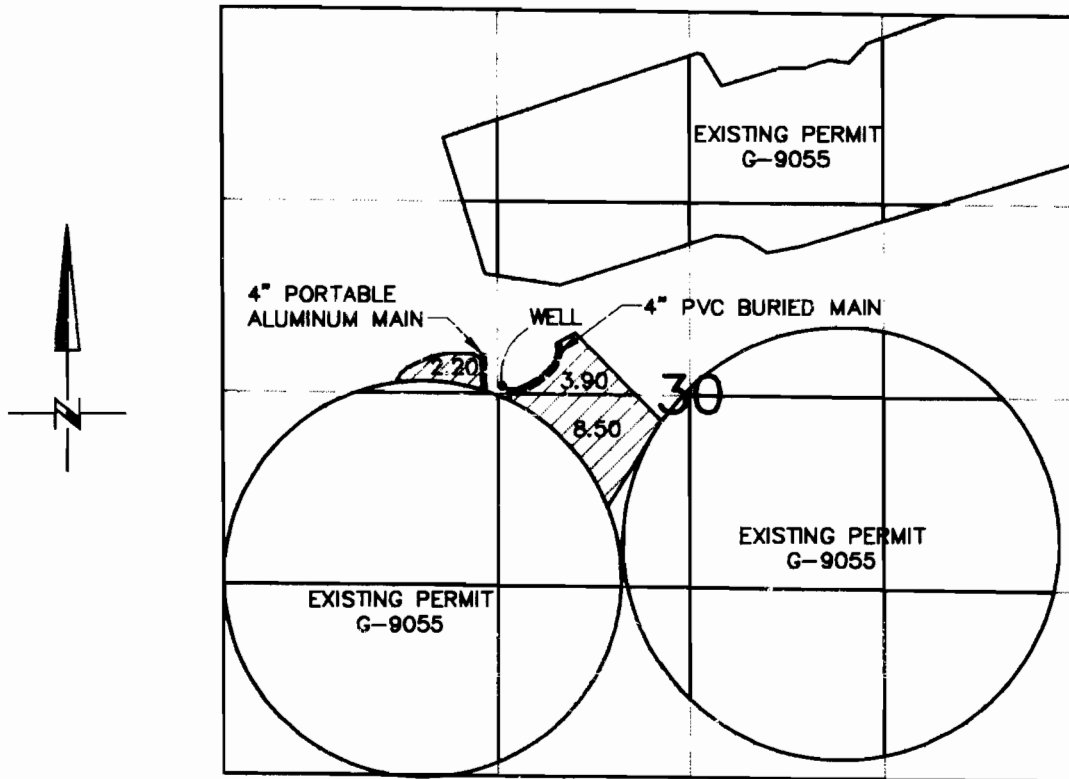

WELL LOCATED 2550' SOUTH AND 3930' WEST FROM THE N.E. COR. SEC. 30

0' 660' 1320' 2640'



SCALE: 1" = 1320'



AREA IRRIGATED

FINAL PROOF SURVEY

FOR

APPLICATION NO. G-11763
PERMIT NO. G-10869

IN NAME OF

J.G. SIMPSON, INC.
ROUTE 2 BOX 109
PENDLETON, OR 97801

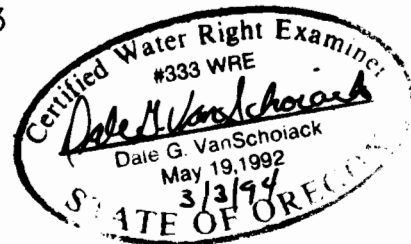

NOTE: THE PURPOSE OF THIS MAP IS TO IDENTIFY THE LOCATION OF THE WATER RIGHT. IT IS NOT INTENDED TO PROVIDE INFORMATION RELATIVE TO THE LOCATION OF PROPERTY OWNERSHIP BOUNDARY LINES.

SURVEYED FEBRUARY 18, 1994