

Map for Cancellation
a portion of
Certificate 20365
Tax Lot 362W15-300
T 36 S, R 2 W, Sec 10, W.M.

SE SE

SW SW

4.9 ac

#1 drain

10

11

NE NE

15

14

NW NW



T1 362W15-300

#2 drain

Unnamed slough

RECEIVED
JUN 02 2008
WATER RESOURCES DEPT.
SALEM, OREGON

Legend

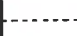
-  Water right certificate 20365
-  Water right to be cancelled
-  Section line
-  Quarter-quarter line

N

0 400 Feet

Rogue River

T. 36 S., R. 2 W., W.M.

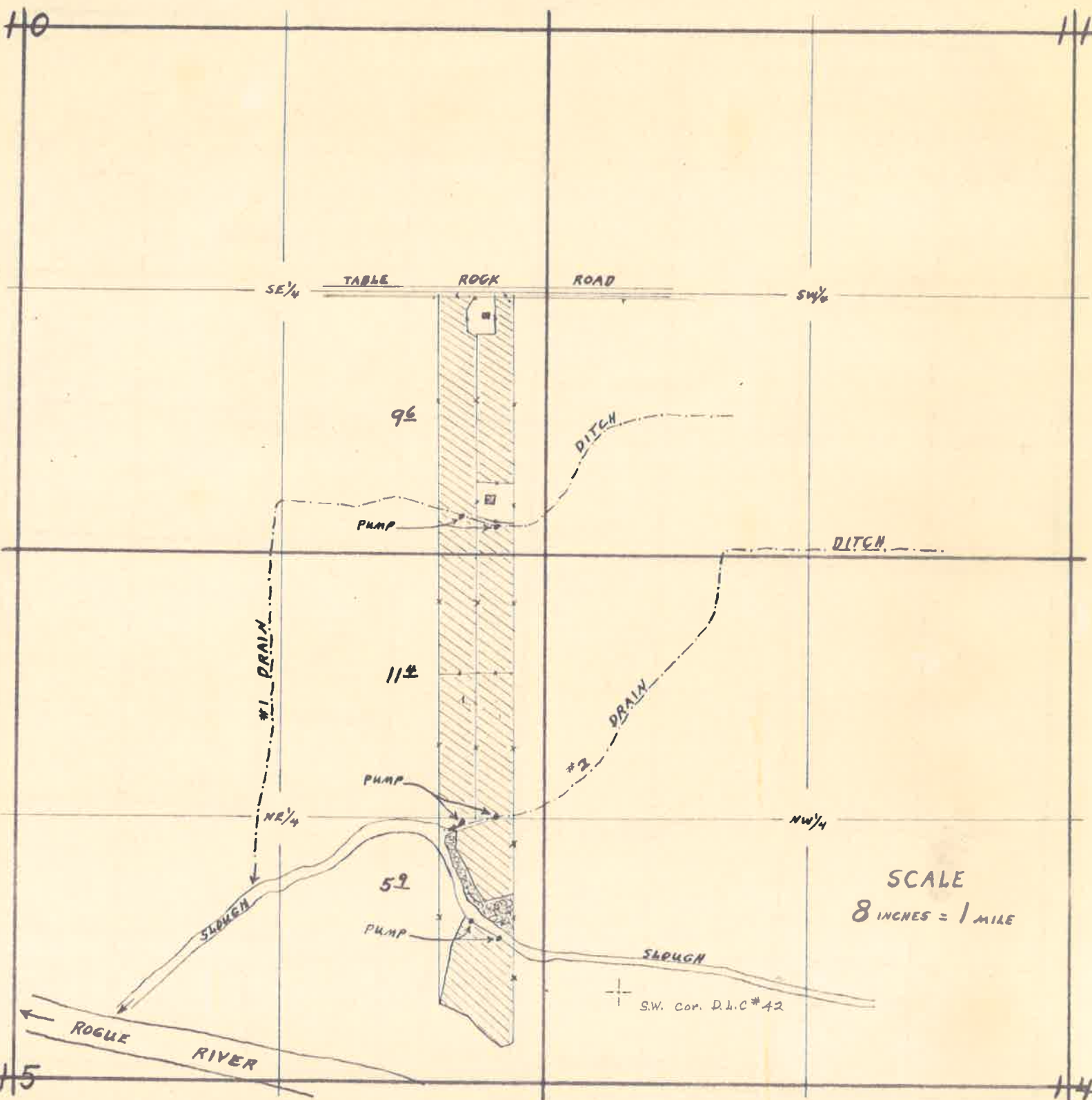

SCALE
 8 INCHES = 1 MILE

MAP ACCOMPANYING FINAL PROOF OF WILLIAM H. BISHOP, FOR USE OF WATER FROM #1 DRAIN DITCH, #2 DRAIN DITCH, AND SLOUGH FOR IRRIGATION PURPOSES.

PERMIT NO. 22381
 APPLICATION NO. 28365

MAP COPIED FROM PLANE TABLE SURVEY - MADE 3-5-54.

CERT. 20365

David L. Hendrix
 WATERMASTER DIST. NO. 15