

T. 3 S., R. 26 E., W.M.

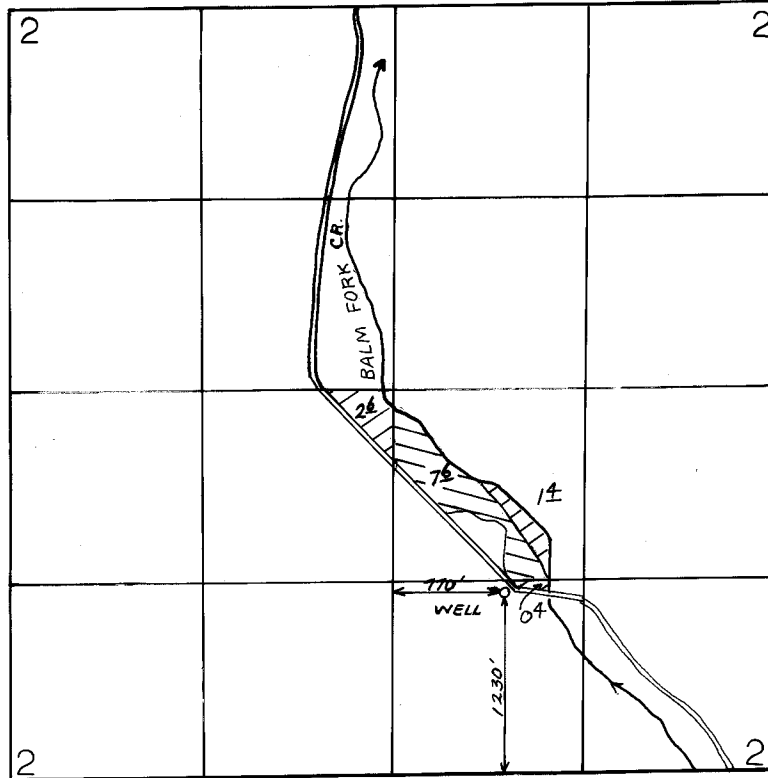

1" = 1320'

PRIMARY



SUPP'L



FINAL PROOF SURVEY

UNDER

Application No. G-6703 Permit No. G-6247
IN NAME OF

CARL W. THORPE

Surveyed 6-9, 1992, by J. MILLER

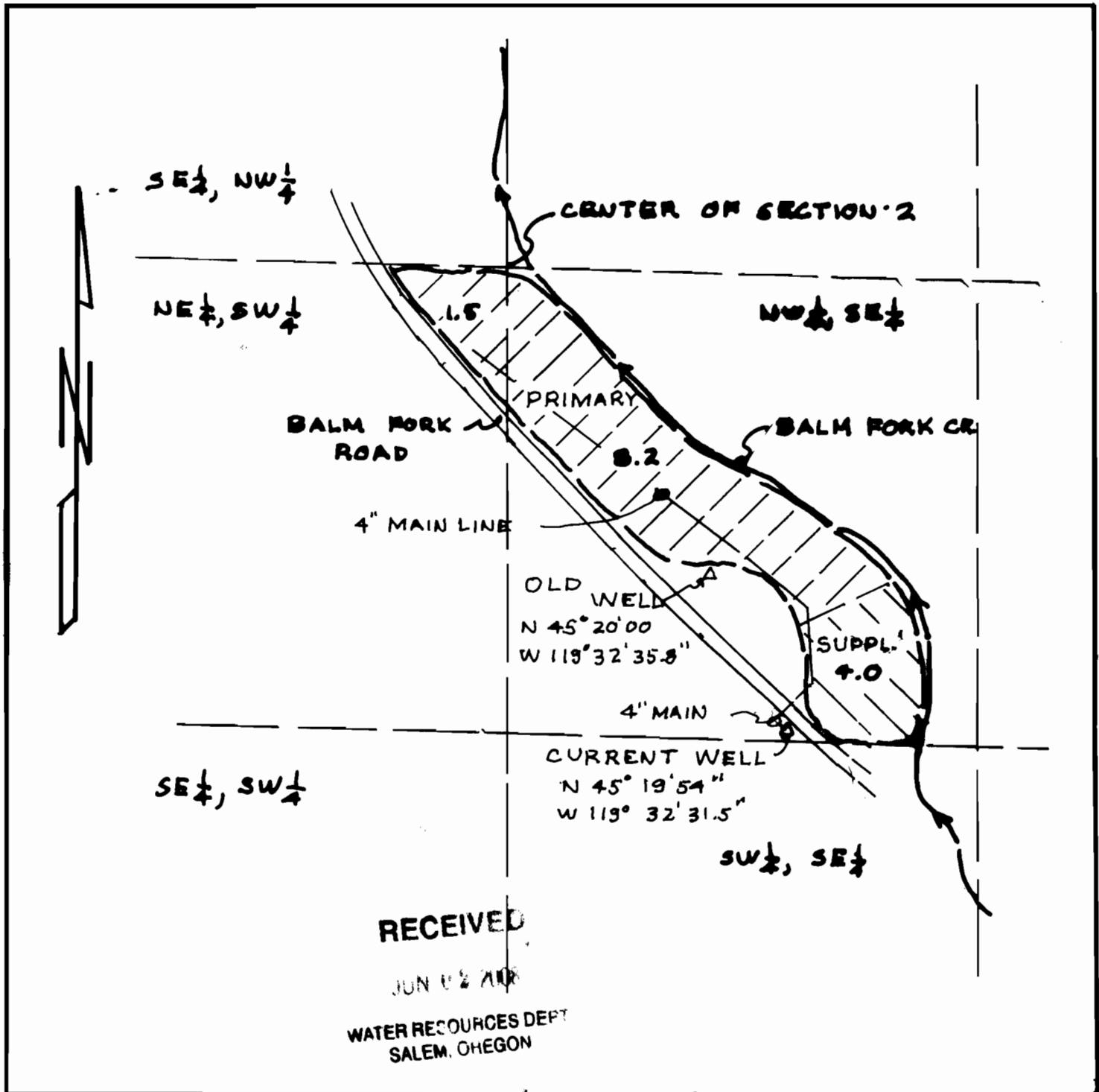

KRUMBEIN ENGINEERING LTD.
 ENGINEERS - SURVEYORS - PLANNERS
 361. S.E. Second Pendleton, Oregon

Scale
 1" = 400'
 Date
 5-3-2009

Drn. By
 DHK
 Ckd. By

Drng. No.
 0820A
 Job No.
 0806

Revision 1
 Revision 2

FINAL PROOF MAP
CARL THORPE
 NE 1/4, SW 1/4 AND NW 1/4, SE 1/4
 SECTION 2, T.35, R.26E W.4
 MORROW COUNTY, OR.



RENEWS 6/30/09

PERMIT G-6247