

FINAL PROOF SURVEY MAP
T27S, R6W, WM
SCALE 1" = 1320'

DOUGLAS COUNTY

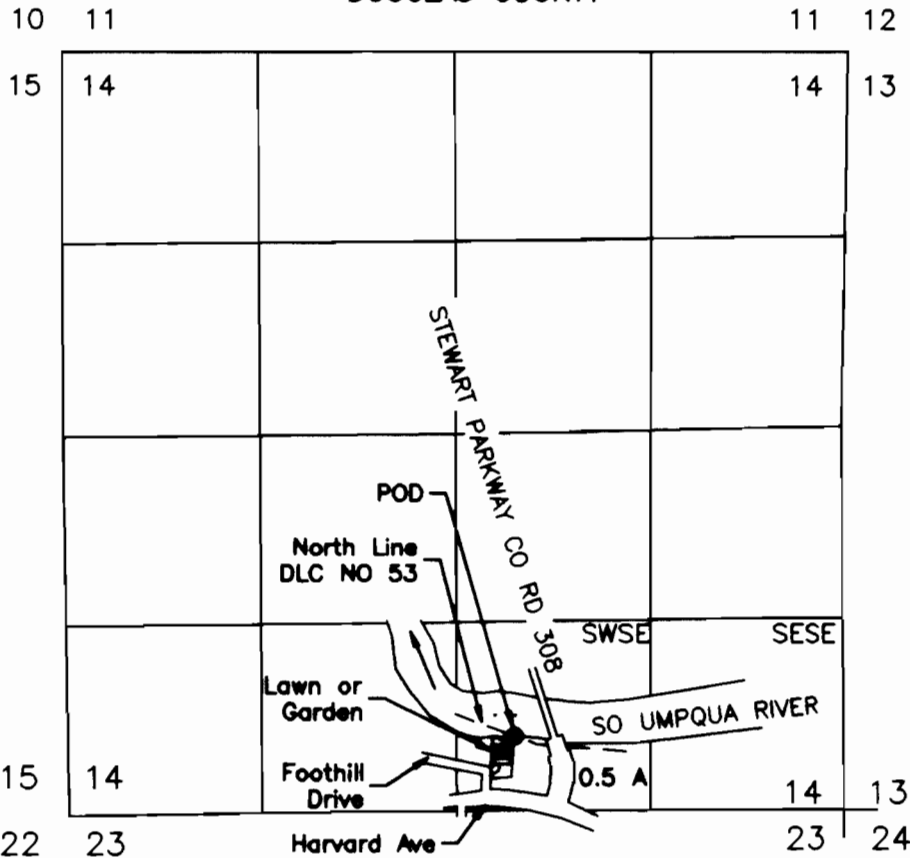

RECEIVED

SEP 28 1999

WATER RESOURCES DEPT.
SALEM, OREGON

POD IS 500 FT N AND 2260 FT W FROM SE COR SEC 14

FINAL PROOF SURVEY
UNDER

Application No. S-71899 Permit No. 51785

IN NAME OF

Susan Morlang

Surveyed July 15, 1999 by M E Farr

THIS IS A LOCATION MAP FOR A FINAL PROOF SURVEY BY SUSAN MORLANG. THIS MAP IS FOR THE PURPOSE OF IDENTIFYING THE LOCATION OF THE WATER RIGHT ONLY AND IS NOT INTENDED TO PROVIDE LEGAL DIMENSIONS OR LOCATIONS OF PROPERTY OWNERSHIP LINES.

MAP PREPARED FOR:
SUSAN MORLANG
2110 FOOTHILL DRIVE
ROSEBURG, OR 97470

MAP PREPARED BY:
MAURICE E FARR, CWRE
395 NE KIRBY AVENUE
ROSEBURG, OR 97470

