

T22S, R10W, WM

SHEET 2 OF 2

FINAL PROOF SURVEY MAP

RALPH B PRESTON OR ALBERTA F PRESTON
Application No. S-73002
Permit No. S-51833

SCALE 1" = 200'

SPRING
APPLICATION NO 16565
PERMIT NO 12349

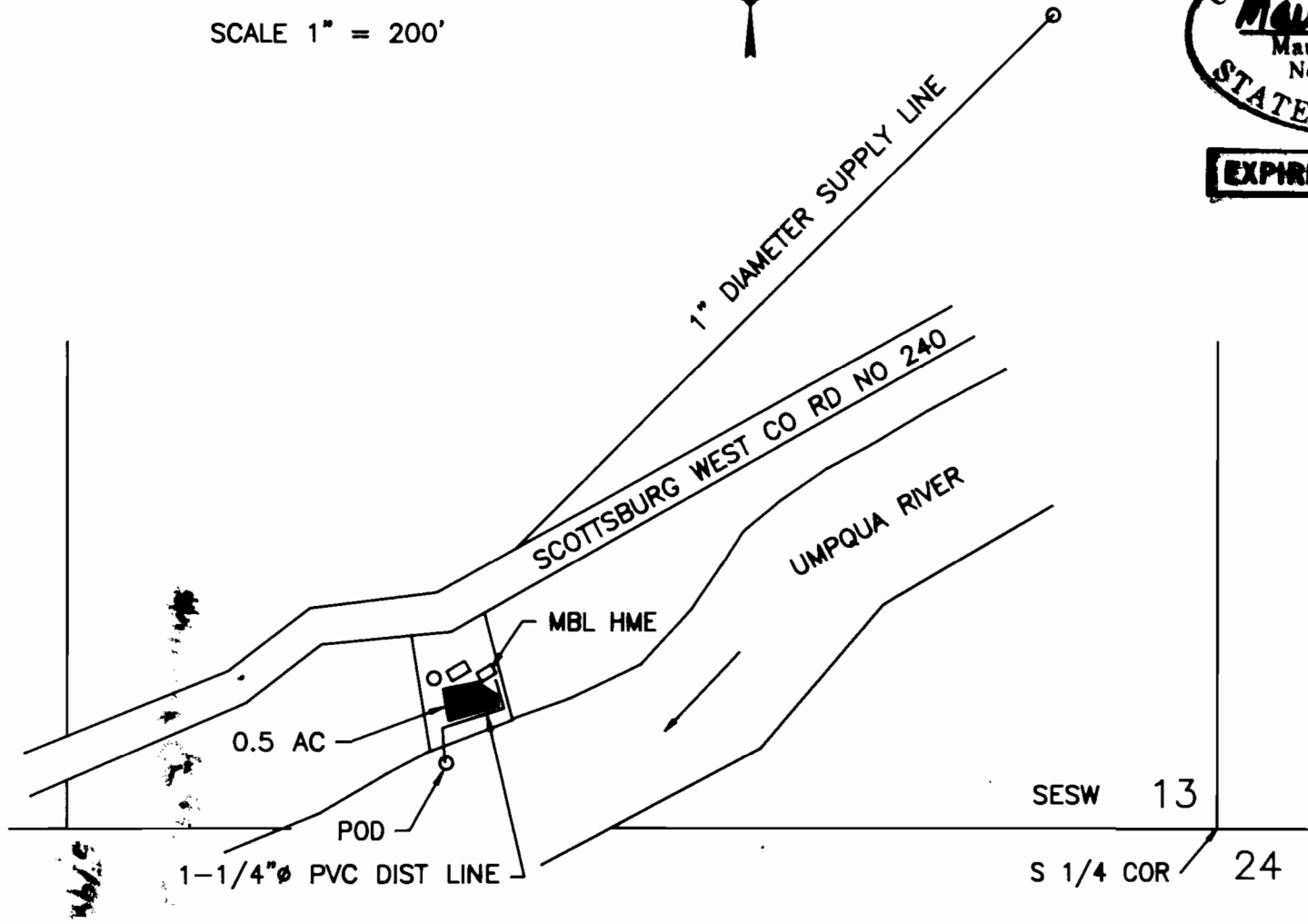

RECEIVED
MAY 19 1993
WATER RESOURCES DEPT.
SALEM, OREGON

RECEIVED

MAY 19 1993

WATER RESOURCES DEPT.
SALEM, OREGON

T22S, R10W, WM

SCALE 1" = 1320'

DOUGLAS COUNTY

SHEET 1 OF 2

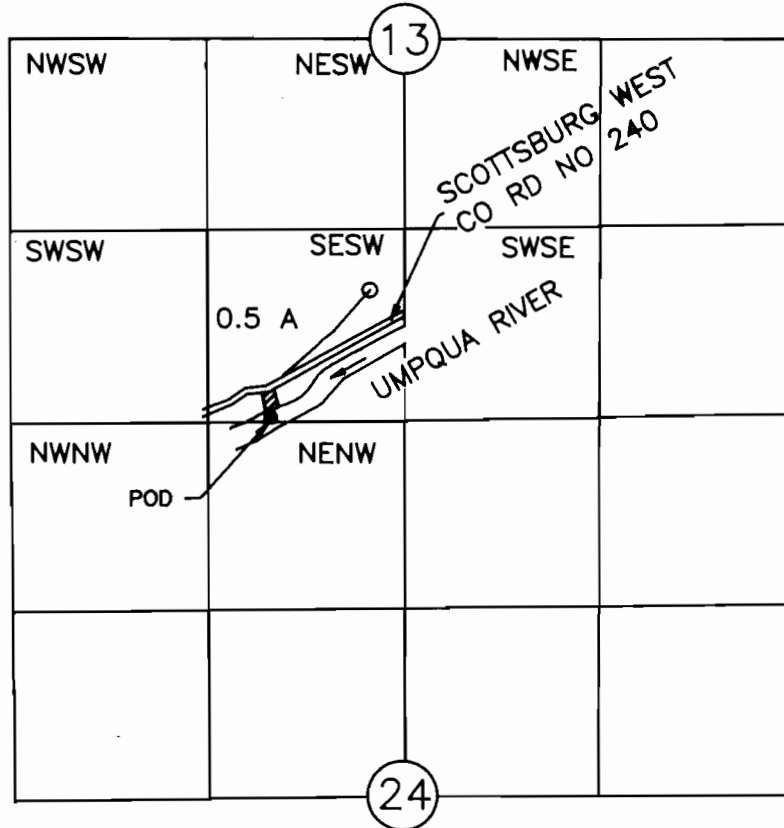

POD IS 50 FT N AND 1780 FT E FROM SW COR SEC 13

FINAL PROOF SURVEY

UNDER

Application No. S-73002 Permit No. S-51833

IN NAME OF

RALPH B PRESTON OR ALBERTA F PRESTON

Surveyed August 9, 1997 by M E Farr

THIS IS A LOCATION MAP FOR A FINAL PROOF SURVEY BY RALPH B PRESTON OR ALBERTA F PRESTON. THIS MAP IS FOR THE PURPOSE OF IDENTIFYING THE LOCATION OF THE WATER RIGHT ONLY AND IS NOT INTENDED TO PROVIDE LEGAL DIMENSIONS OR LOCATION OF PROPERTY OWNERSHIP LINES.

