

**RECEIVED**

JUN - 3 1998

WATER RESOURCES DEPT.  
SALEM, OREGON

T22S, R10W, WM

SCALE 1" = 1320'

DOUGLAS COUNTY

SHEET 1 OF 2

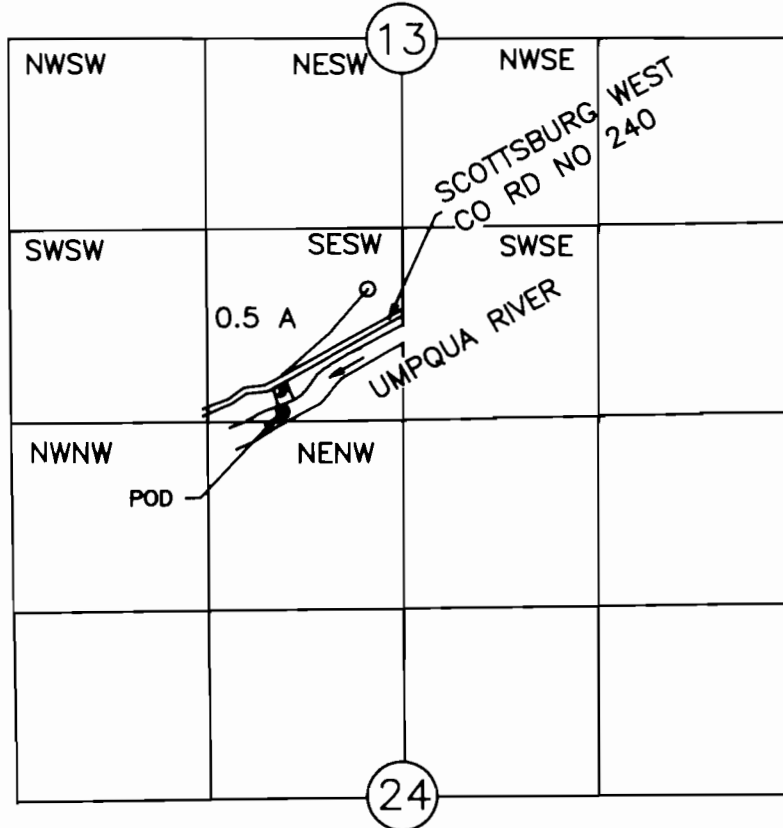

POD IS 90 FT N AND 1870 FT E FROM SW COR SEC 13

# FINAL PROOF SURVEY UNDER

Application No. S-73011 Permit No. S-51832

IN NAME OF

NICK OR ESTHER NICASTRO

Surveyed August 9, 1997 by M E Farr

THIS IS A LOCATION MAP FOR A FINAL PROOF SURVEY BY NICK OR ESTHER NICASTRO. THIS MAP IS FOR THE PURPOSE OF IDENTIFYING THE LOCATION OF THE WATER RIGHT ONLY AND IS NOT INTENDED TO PROVIDE LEGAL DIMENSIONS OR LOCATION OF PROPERTY OWNERSHIP LINES.

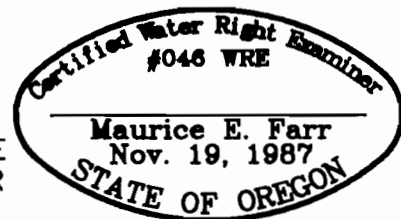

EXPIRES 12-31-99

T22S, R10W, WM

SHEET 2 OF 2

FINAL PROOF SURVEY MAP

NICK OR ESTHER NICASTRO  
Application No. S-73011  
Permit No. S-51832

SCALE 1" = 200'

SPRING  
APPLICATION NO 16565  
PERMIT NO 12349

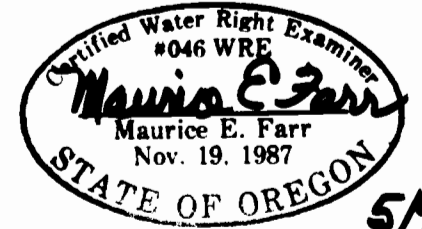

**EXPIRES 12-31-99**

5/98

