

T.17S. R.21E. W.M.

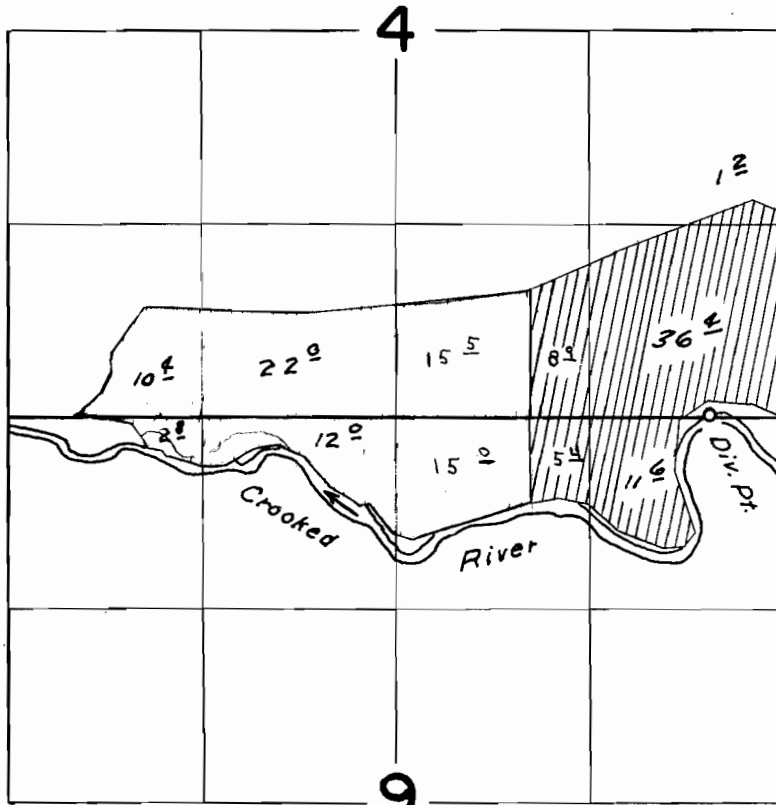

DIV. PT.: 10' N. & 500' W. OF SE. COR. SEC. 4

FINAL PROOF SURVEY
UNDER

Application No. 33918... Permit No. 26748...
IN NAME OF

LES SCHWAB

Surveyed Oct. 8, 1964, by C.J. Gardner...