

FINAL PROOF GROUND WATER RIGHT MAP
 PERMIT NO. G-11989, APPLICATION NO. G-11732

LOCATED IN
 SECTION 16, T. 14 S., R. 15 E., W.M.
 TAX MAP 14-15-16, TAX LOT 400
 CROOK COUNTY, OREGON

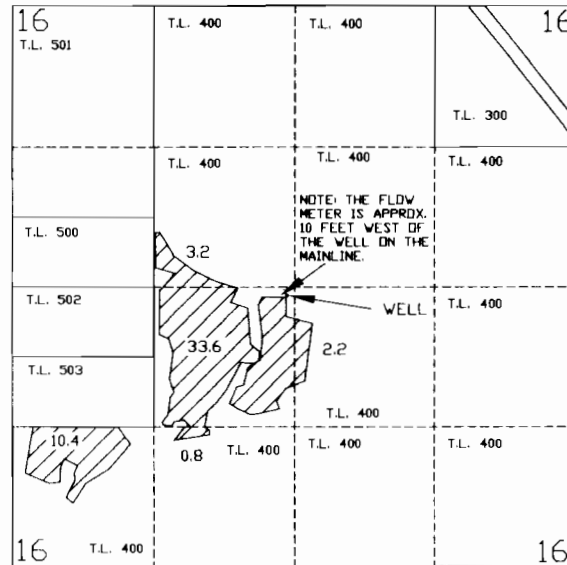
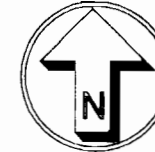

GROUND WATER RIGHT- PERMIT NO. G-11989

WELL LOCATION: 2562 FT. NORTH AND
 2711 FEET WEST OF SE CORNER SEC. 16

COBU MAP # 0348

I, ROBERT E. BAXTER, CERTIFIED WATER RIGHT EXAMINER
 IN THE STATE OF OREGON, HEREBY CERTIFY THAT THIS
 WATER RIGHT SURVEY MAP WAS PREPARED BY ME.

THE PREPARATION OF THIS MAP IS FOR THE PURPOSE
 OF IDENTIFYING THE LOCATION OF THE WATER RIGHT
 ONLY AND HAS NO INTENT TO PROVIDE DIMENSIONS OR
 LOCATIONS OF PROPERTY OWNERSHIP LINES.

RECEIVED
 MAY 19 2008
 WATER RESOURCES DEPT
 SALEM, OREGON

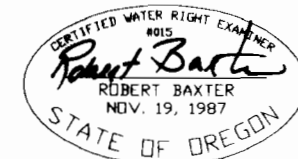

PREPARED BY
 BAXTER LAND SURVEYING, INC.
 20370 EMPIRE AVE. SUITE C3
 BEND, ORE. 97701 (541) 382-1962

FINAL PROOF GROUND WATER RIGHT MAP
 FOR
 QUAIL VALLEY RANCH III

PREPARED FOR: BILL COLSON
 QUAIL VALLEY RANCH
 2250 MCGILCREST STREET SE, SUITE 200
 SALEM, OR 97302
 DATE: 9/21/05 SCALE: 1" = 1320'