

Tax lot No. TL1700&TL1800 23 12 29BD

Section 29 Township 23S Range 12W W.M.
Coos County

RECEIVED

JUL 30 1998

WATER RESOURCES DEPT.
SALEM, OREGON

NW1/16

CN1/16



Scale 1" = 400'

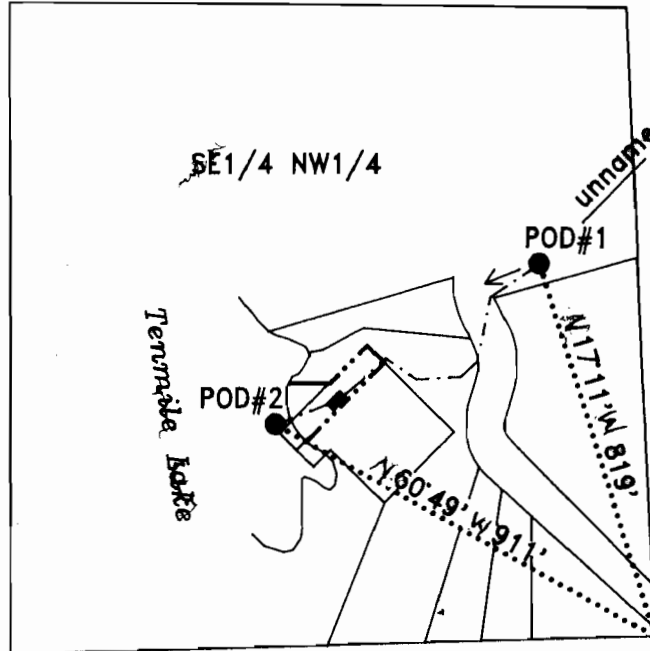

LEGEND

- HOME
- POINT OF DIVERSION
- - - - - WATERLINE
- · - · - · - PROPERTY LINE

EXAMINERS DISCLAIMER STATEMENT

The preparation of this map was for the purpose of identifying the location of the Water Right only and has no intent to provide dimensions or location of property ownership lines.

AMENDED BY WRD Staff
6-24-08
TWJ

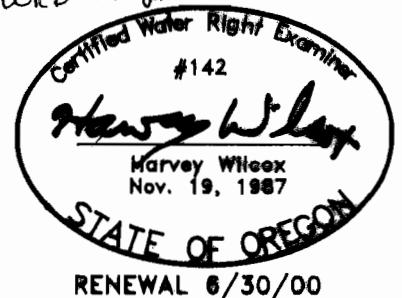

FINAL PROOF SURVEY

IN THE NAME OF

Doretta J. Littrell

Surveyed on 6/9/98 by H.A. Wilcox

Application No. S-81218
Permit No. 53201