

— MAP —

Accompanying application of LOUIS. C. SCHAFER of Central Point, Jackson County, Oregon. for permit to the waters of Rogue River. for Irrigation use.

— February 1926. —

TP 36 S. R 2 W. W. M.

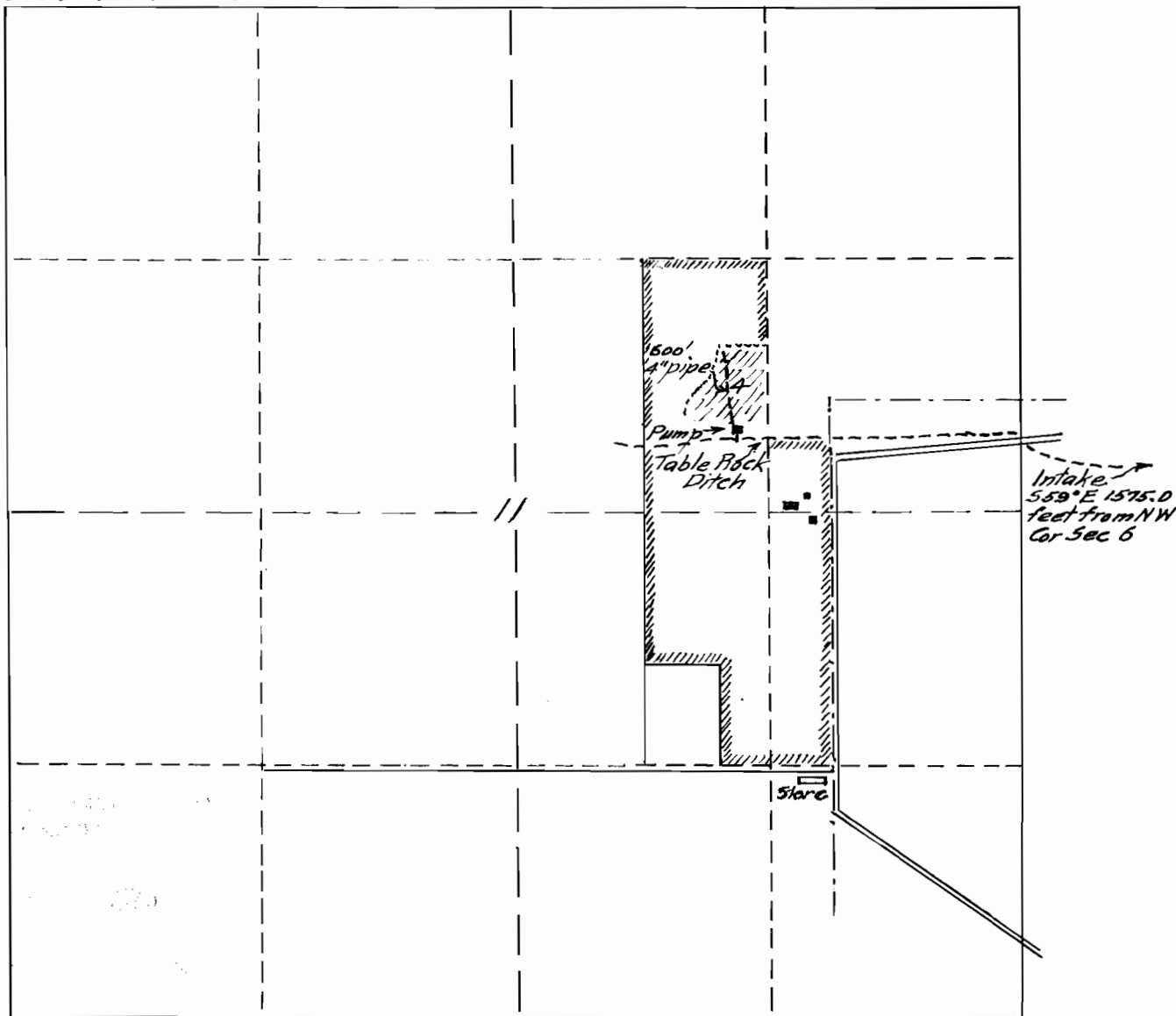

Map made from plat of Louis C. Schafer lands, the same showing correctly, the lands to be irrigated, together with streams and ditches in immediate vicinity compiled by.

Application No. 10595
Permit No. 7434

— Fred. N. Cummings. C.E. —