

FINAL PROOF MAP  
T22S, R9W, WM

SCALE 1' = 1320'  
DOUGLAS COUNTY

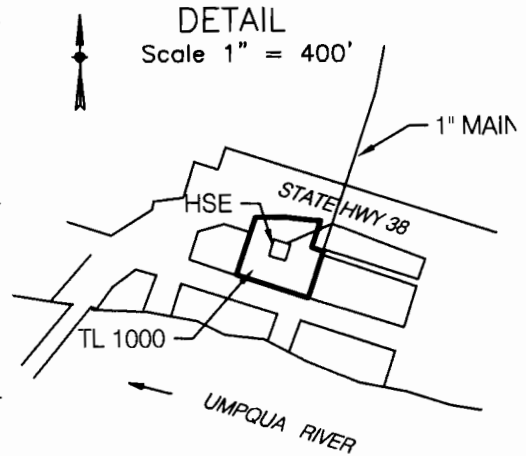
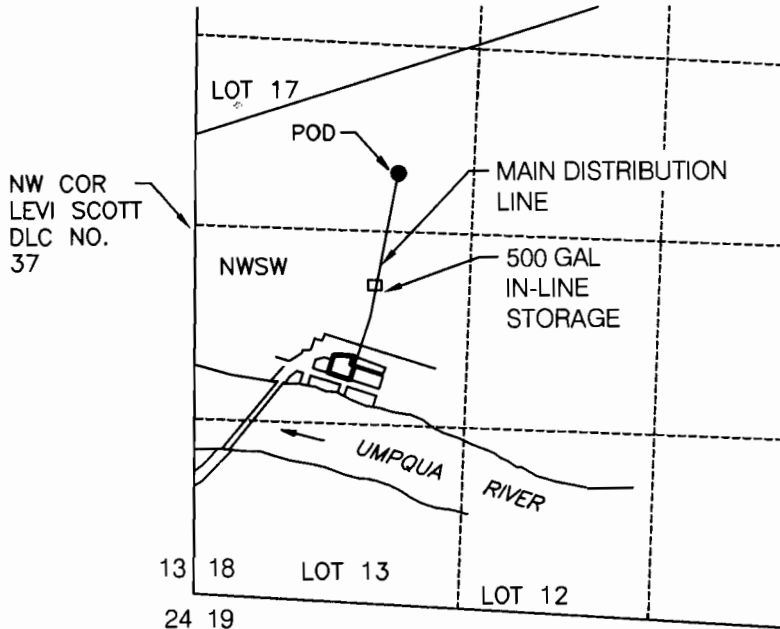

POD IS 2275 FT S AND 1350 FT E FROM NW COR SEC 18

FINAL PROOF SURVEY

UNDER

Application No. S-86467 Permit No. S-54374

IN NAME OF

James Johnson

Surveyed May 21, 2007 by M E Farr

JAMES JOHNSON  
263 GLENWOOD COURT  
ROSEBURG, OR 97470

MAURICE E FARR, CWRE  
395 NE KIRBY AVENUE  
ROSEBURG, OR 97470

THIS IS A LOCATION MAP FOR A FINAL PROOF SURVEY BY JAMES JOHNSON. THIS MAP IS FOR THE PURPOSE OF IDENTIFYING THE LOCATION OF THE WATER RIGHT ONLY AND IS NOT INTENDED TO PROVIDE LEGAL DIMENSIONS OR LOCATIONS OF PROPERTY OWNERSHIP LINES.

**RECEIVED**

MAY 22 2007

WATER RESOURCES DEPT  
SALEM OREGON

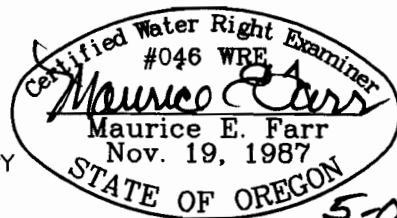

EXPIRES 12-31-07

5-07