

RECEIVED

AUG 17 2007
WATER RESOURCES DEPT
SALEM OREGON

CLAIM of BENEFICIAL USE
for BETTY NEER
in the N 1/2 of NW 1/4 SEC 12
TWP 6 N, RGE 2 W,
COLUMBIA COUNTY, ORE.

APPLICATION # S-85498
PERMIT # 53976

OWNER: BETTY NEER
70708 NEER CITY RD.
RAWIER, ORG 97048

CWRE: LESLIE KEENON
16721 NOAKES RD.
VERNONIA, ORE 97064

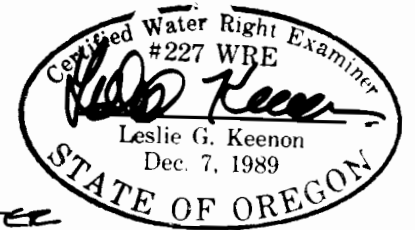

SCALE 1" = 400'

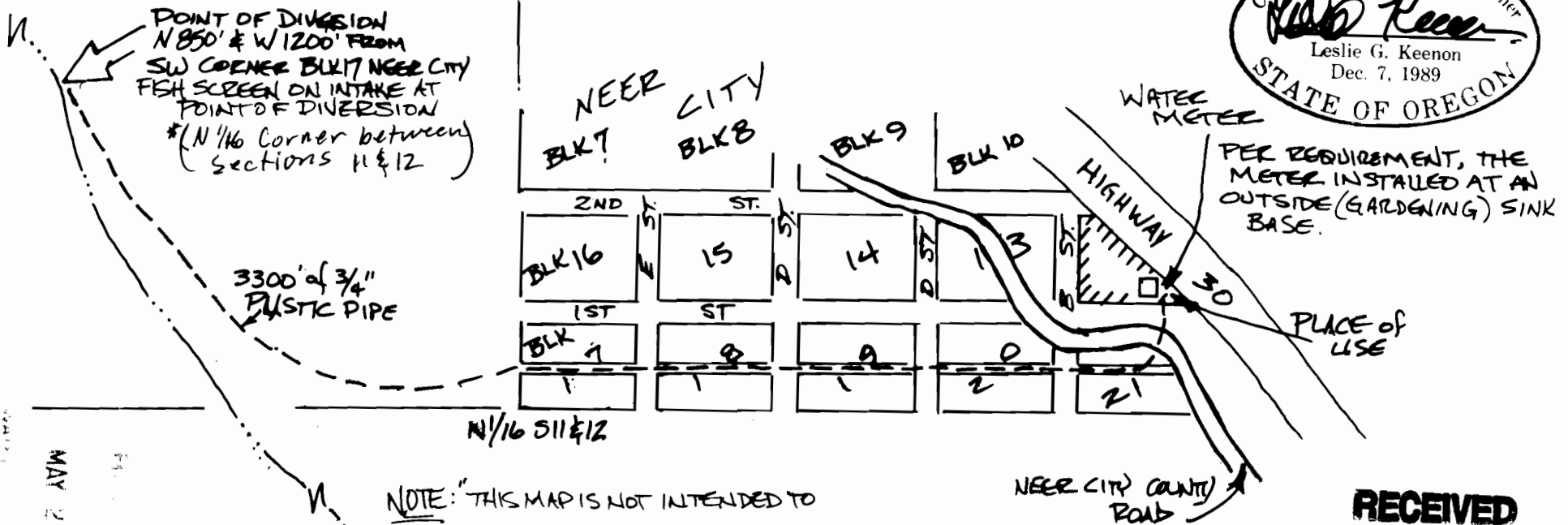

NOTE: "THIS MAP IS NOT INTENDED TO
PROVIDE LEGAL DIMENSIONS OR LOCATIONS
OF PROPERTY OWNERSHIP LINES."

MAY 21 2007

*Map amended to 600000

RECEIVED

SEP 21 2007

WATER RESOURCES DEPT
SALEM, OREGON