

FINAL PROOF SURVEY MAP

IN THE NAME OF RAYMOND GARDNER

SECTION 29, T 28 S, R 14 W, W.M.

APPLICATION G-11941

PERMIT G-11394

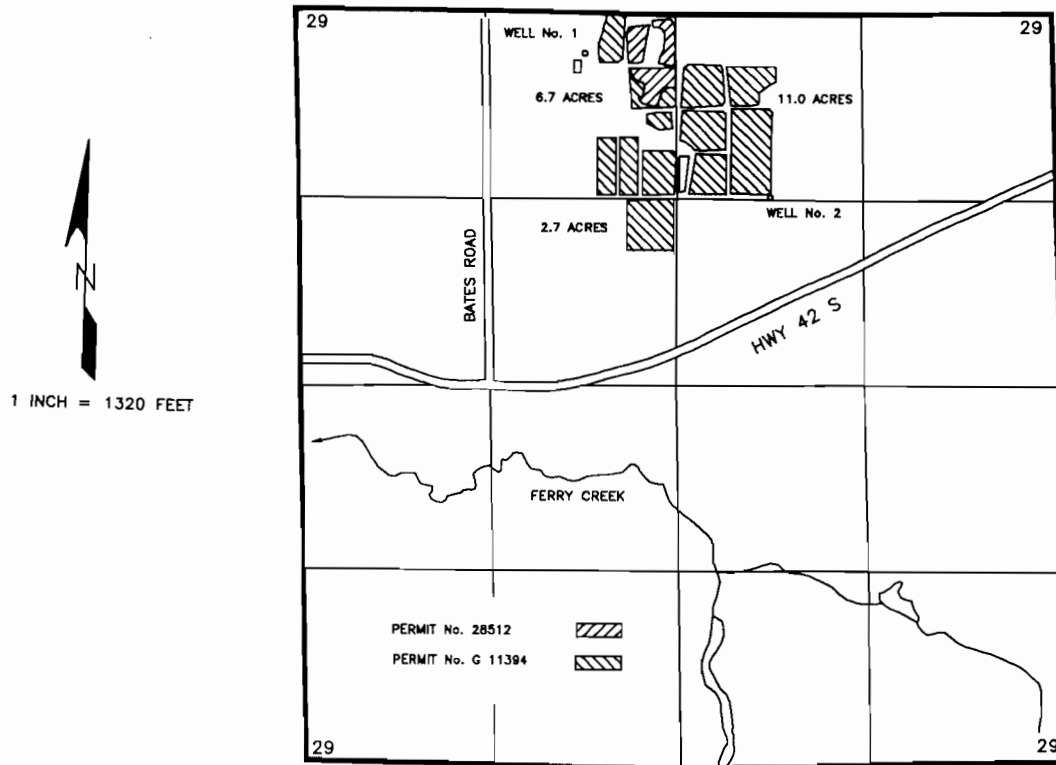

THE POINTS OF DIVERSION ARE LOCATED AS FOLLOWS:

DIVERSION	SOUTH	EAST	¼ ¼	SECTION
WELL No. 1	300 FEET	2,000 FEET	NE¼ NW¼	29
WELL No. 2	1,290 FEET	3,280 FEET	NW¼ NE¼	29

BOTH FROM THE NORTHWEST CORNER OF SECTION 29, AND WITHIN SECTION 29, TOWNSHIP 28 SOUTH, RANGE 14 WEST, W.M.; IN COOS COUNTY.

THE PURPOSE OF THIS MAP IS TO IDENTIFY THE LOCATION OF THE WATER RIGHT. IT IS NOT INTENDED TO PROVIDE INFORMATION RELATIVE TO THE LOCATION OF PROPERTY OWNERSHIP BOUNDARY LINES.

Raymond P. Gardner