

RECEIVED

T12S, R6W, W. M.

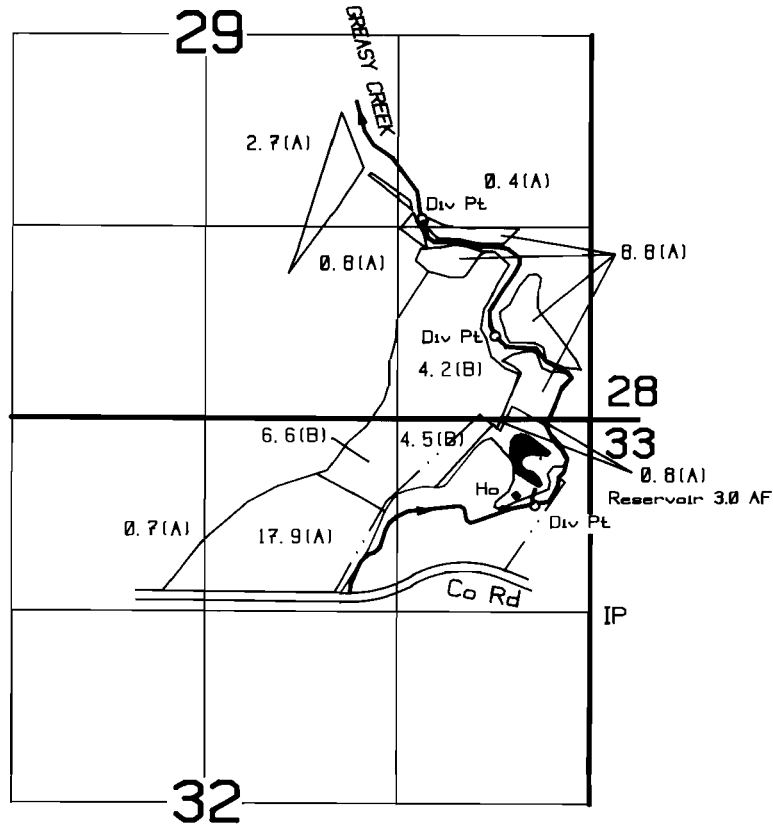

REMAINING ACREAGE:

(A) PERMIT NO 37459, CERT NO. 68386 (10/5/72) - 32.8 ACRES
(B) PERMIT NO 14311, CERT NO. 68385 (4/23/40) - 25.3 ACRES

RESERVOIR DIV PT 740' NORTH & 380' WEST FROM N1/16, SEC 32 & 33

1" = 1320'

FINAL PROOF SURVEY
UNDER

Transfer Application No. T-6661
Reservoir Application R-71737, PERMIT R-11415

IN THE NAME OF
ROBERT MEISTER

Surveyed December 7, 1994
PARSONS SURVEYING
1915 SE Stone Street
Corvallis, OR 97333
(503) 752-7515
PROJECT No 9474

NOTE: Map is for purpose of identifying location of water right and does not dimension or locate property ownership lines.

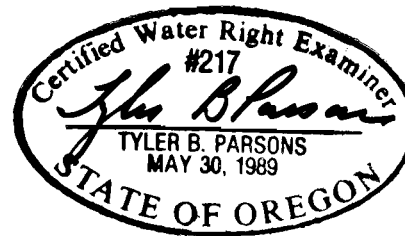

EXP: 12/31/96