

CLAIM OF BENEFICIAL USE
 SURVEYED SEPTEMBER 15, 2000
 BY DUANE KIRBY
 FOR DAYS CREEK
 SCHOOL DISTRICT 15
 APPLICATION S-80676 PERMIT 53542
 T30S R4W WM

1 INCH = 1320 FEET

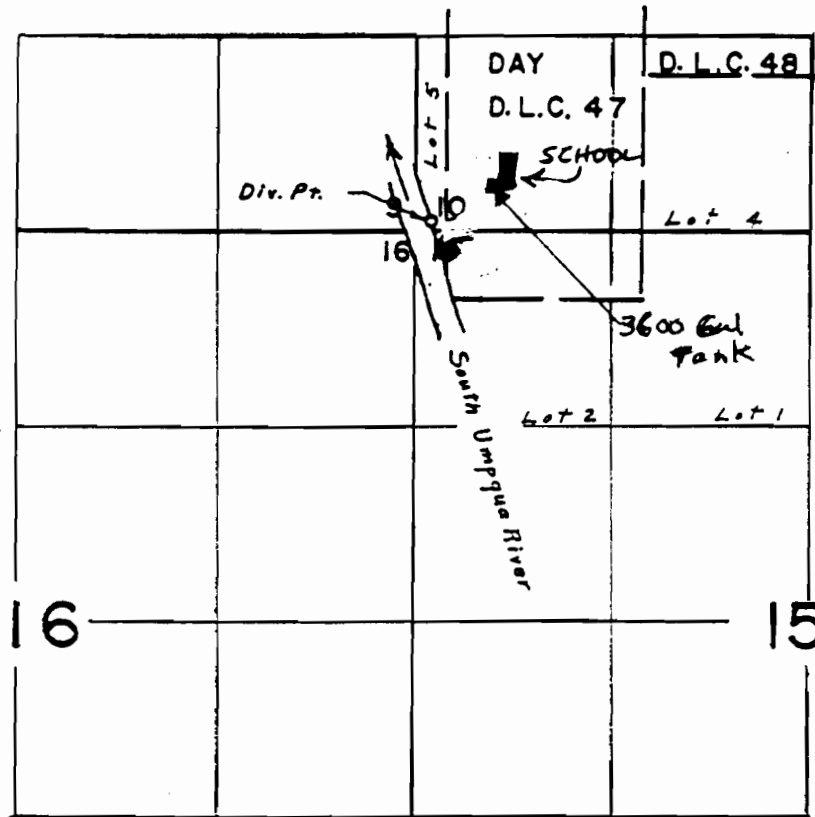

Div. Pt. located 60' N. & 90' E. from S.W. Corner Section 10

RECEIVED

SEP 21 2000

WATER RESOURCES DEPT.
 SALEM, OREGON

THE PURPOSE OF THIS MAP IS TO IDENTIFY THE LOCATION OF THE WATER RIGHT. IT IS NOT INTENDED TO PROVIDE INFORMATION RELATIVE TO THE LOCATION OF PROPERTY OWNERSHIP BOUNDARY LINES.

