

FINAL PROOF SURVEY

T 40 S R 13 E WM.

NE 1/4 NE 1/4 SECTION 8

application # 74691 permit # 53155

For: CARL D. GIBSON

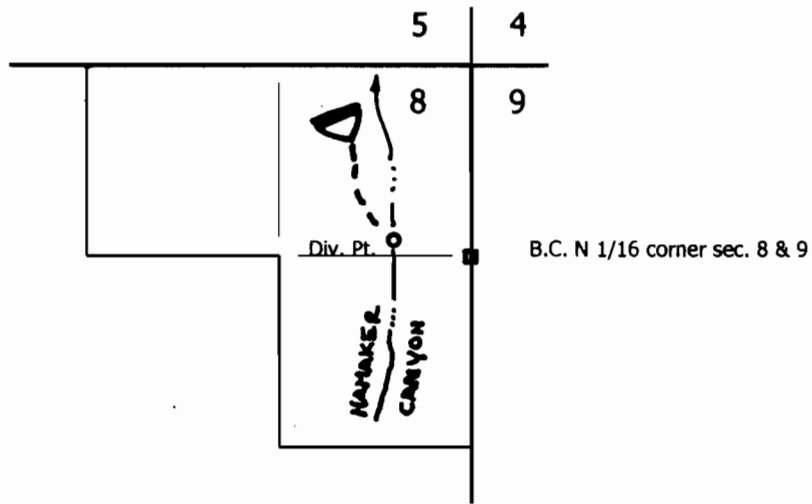
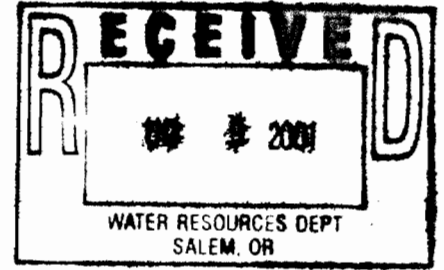

diversion point location: N 84 W, 570' from the N 1/16 corner section 8 & 9

Scale 1" = 1320'

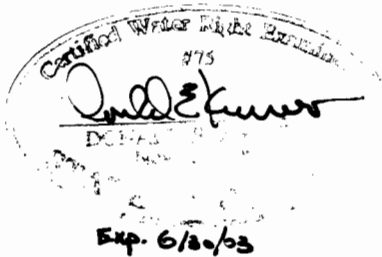

This map is to be used for water right purposes only.

Don Knauer Consulting
PO Box 5416
Salem, OR 97304
503-585-8474