

# T3N., R8W., W.M.

RECEIVED

OCT - 8 1997

WATER RESOURCES DEPT  
SALEM, OREGON

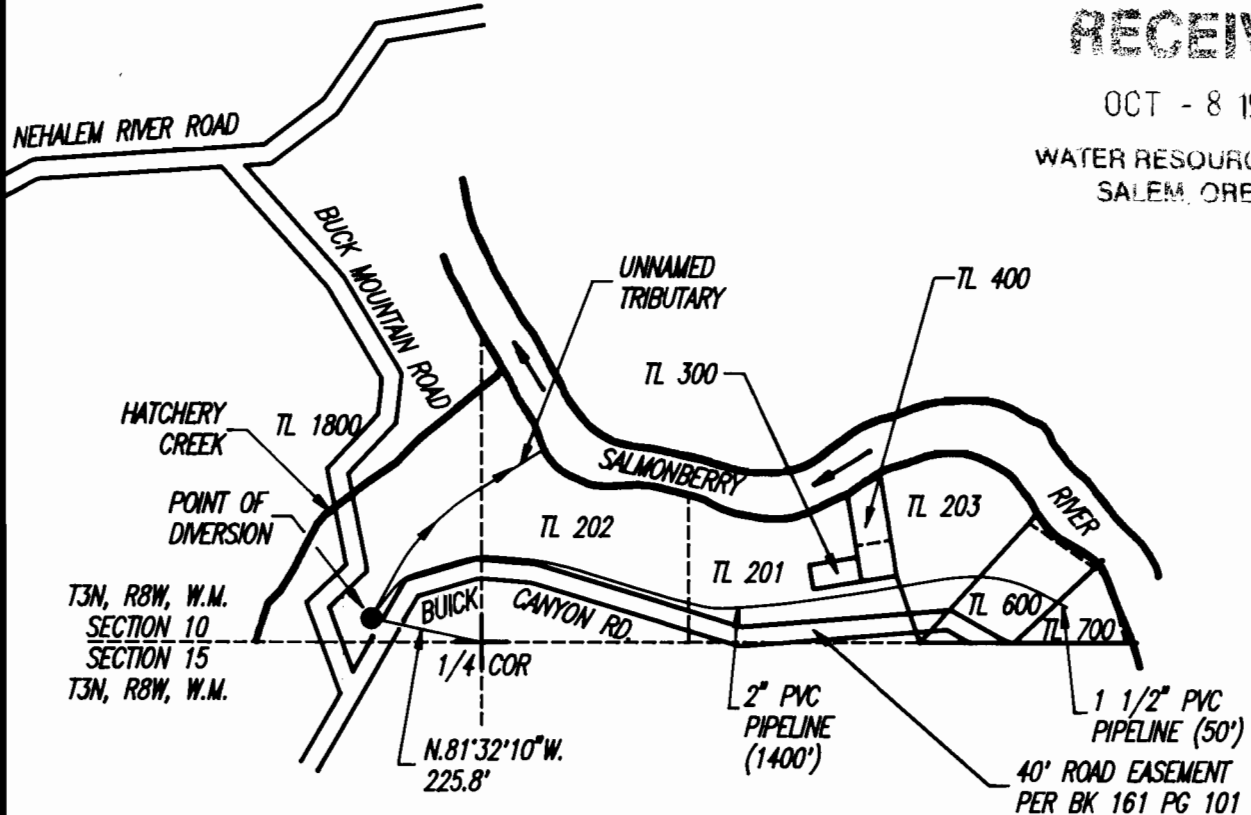

WATERLINE EASEMENT IS PER  
DOCUMENT RECORDED IN BOOK  
245 PAGE 39, TILLAMOOK COUNTY  
RECORDS OF MISCELLANEOUS  
AGREEMENTS.

HUMAN CONSUMPTION PURPOSES

0.01 CFS =  
DUTY OF WATER  
= 4.49 G.P.M.

## FINAL PROOF SURVEY

UNDER

Application No. S-73435 Permit No. S-53112

IN NAME OF

MICHAEL E. HENNINGSSEN

Surveyed SEPTEMBER 18, 1997, by A.M. KLEIN



SCALE: 1" = 400'



EXPIRES 06/30/99

THIS MAP IS FOR THE PURPOSE  
OF IDENTIFYING THE LOCATION OF  
THE WATER RIGHT ONLY AND IS  
NOT INTENDED TO PROVIDE LEGAL  
DIMENSIONS OR THE LOCATION  
OF PROPERTY OWNERSHIP LINES.