

**T5N, R35E, S3 & 4, WM
UMATILLA COUNTY**

● POA is a well in the Goodman Spring Branch Basin, located 2500 feet South from NW Corner of Section 3.

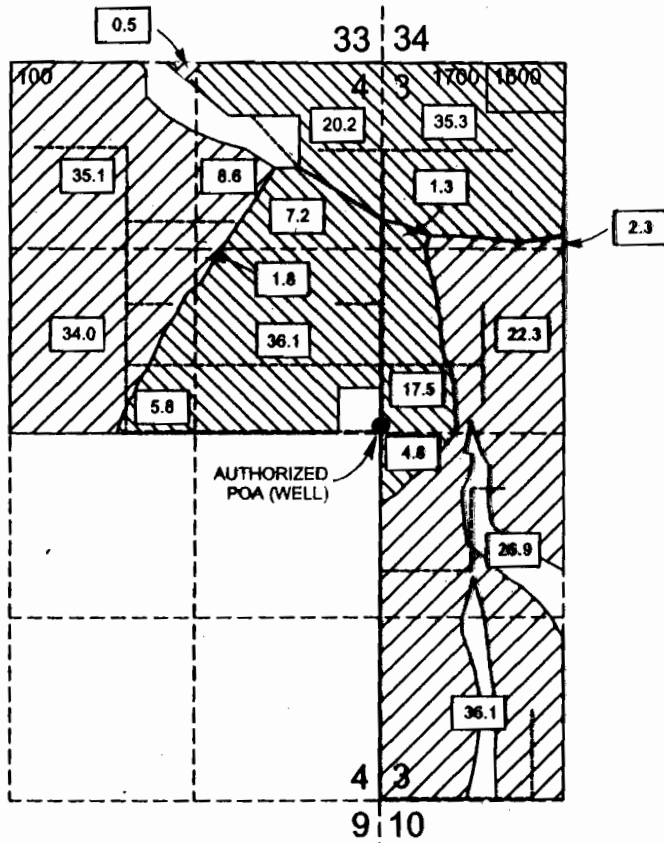

PLACE OF USE (PRIMARY)

467.4 acres as follows:

SEC 3	NW/NW	2.3 ac
	SW/NW	22.3 ac
	NW/SW	26.9 ac
	SW/SW	36.1 ac
SEC 4	NE/NE	8.6 ac
	NW/NE	36.4 ac 35.6
	SW/NE	34.0 ac
	SE/NE	1.8 ac

PLACE OF USE (SUPPLEMENTAL)

126.7 acres as follows:

SEC 3	NW/NW	36.6 ac
	SW/NW	17.5 ac
	NW/SW	4.8 ac
SEC 4	NE/NE	27.4 ac
	NW/NE	0.5 ac
	SW/NE	5.8 ac
	SE/NE	36.1 ac

WATER CONVEYANCE

Water conveyed from well to discrete irrigation zones (zone control valves) with buried PVC mainline pipe of 12, 10 and 8-inch diameter. Water distributed within irrigation zones with buried PVC submains and laterals of varying sizes. Water applied to apples and wine grapes. Water applied to apples with Nelson R2000 rotators with K2-15 rotor plates and #8.3 (gray) nozzles on 14-by-48-foot spacing. Water applied to wine grapes with 0.5-inch diameter RAM tubing with 0.42 gph pressure compensating drip emitters on 9-foot-by-30-inch spacing.



1 in = 1320 ft

CWRE Seal & Signature

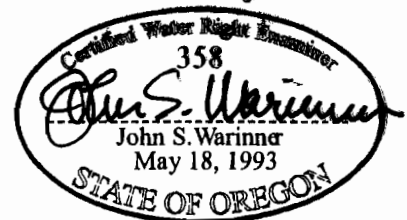

FINAL PROOF SURVEY MAP

Application G-11954 -- Permit G-10990
Amendment of Map Dated 27 SEP 1994

In the name of
Earl E. Brown & Sons, Inc.
PO Box 249
Milton-Freewater, OR 97862

Revised by John Warinner 28 APR 2008

AMENDED 5/6/08 WRD-LHN

The purpose of this map is to identify the location of a water right. It is not intended to provide information regarding the location of property ownership boundary lines.

FOUNTAINHEAD

PO Box 2197 Walla Walla, WA 99362
Phone: 509.529.2646 Fax: 509.522.5251