

RECEIVED

OCT 8 1993

WATER RESOURCES DEPT.
SALEM, OREGON

NE 1/4, SE 1/4, SECTION 20

T.36 S. R.5 W. W.M.

THIS MAP IS FOR THE PURPOSE OF IDENTIFYING THE LOCATION OF THE WATER RIGHT ONLY AND IS NOT INTENDED TO PROVIDE LEGAL DIMENSIONS OR LOCATIONS OF PROPERTY OWNERSHIP LINES.



SCALE: 1" = 400'

BURIED IRRIGATION
PIPE LINE

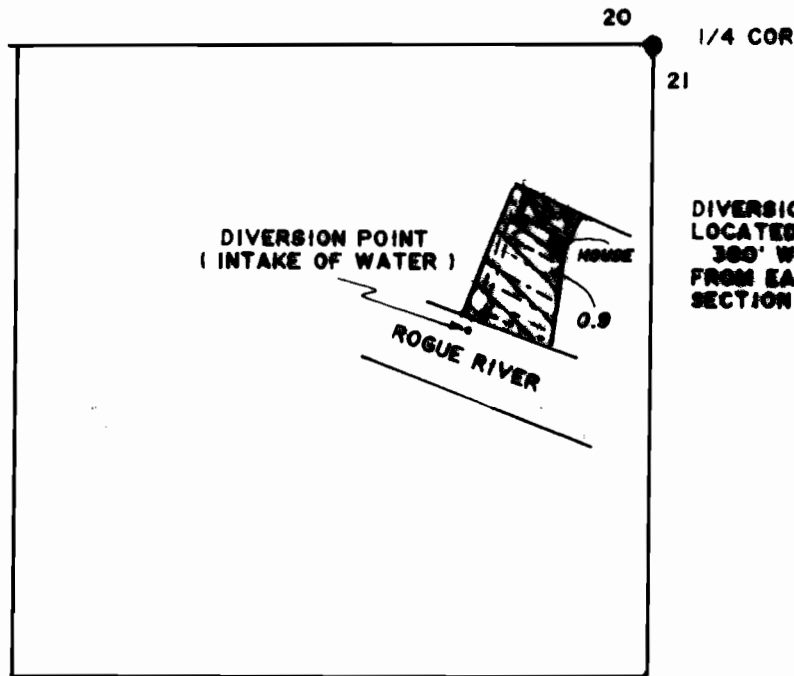

DIVERSION POINT IS LOCATED 890' SOUTH & 300' WEST FROM EAST 1/4 COR SECTION 20

FINAL PROOF SURVEY
UNDER

APPLICATION NO. 69687 PERMIT NO. 51301

IN THE NAME OF
ROBERT W. BONNER

SURVEYED SEPTEMBER 23, 1993

BY JONATHAN C. SPERO C.W.R.E. # 123

