

SECTION 1  
NW 1/4 OF THE SE 1/4  
TOWNSHIP 10 SOUTH, RANGE 10 WEST, WILLAMETTE MERIDIAN  
LINCOLN COUNTY, OREGON

SCALE 1" = 400 FT

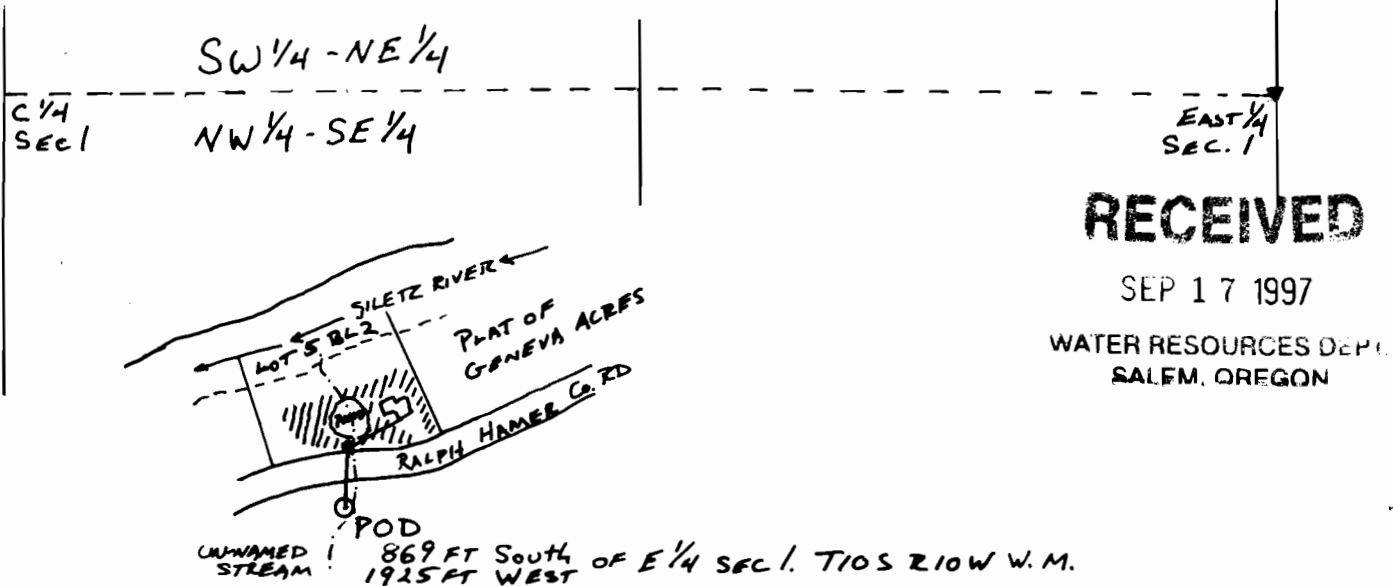
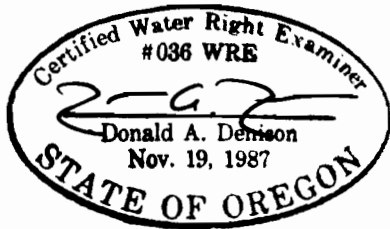

**RECEIVED**

SEP 17 1997

WATER RESOURCES DEPT.  
SALEM, OREGON

FINAL PROOF SURVEY UNDER

APPLICATION #72236

PERMIT #72236

IN THE NAME OF:  
RON ANDERSON

SURVEYED: MARCH 9, 1996

BY: DON A. DENISON, CWRE #036

THIS MAP IS PREPARED SOLELY FOR THE PURPOSE OF SHOWING THE LOCATION OF A WATER RIGHT, AND IS NOT INTENDED FOR USE FOR PROVIDING DIMENSIONS OR LOCATIONS OF PROPERTY OWNERSHIP LINES. THIS IS NOT A BOUNDARY SURVEY.