

# T. 17S, R. 10W. W.M.

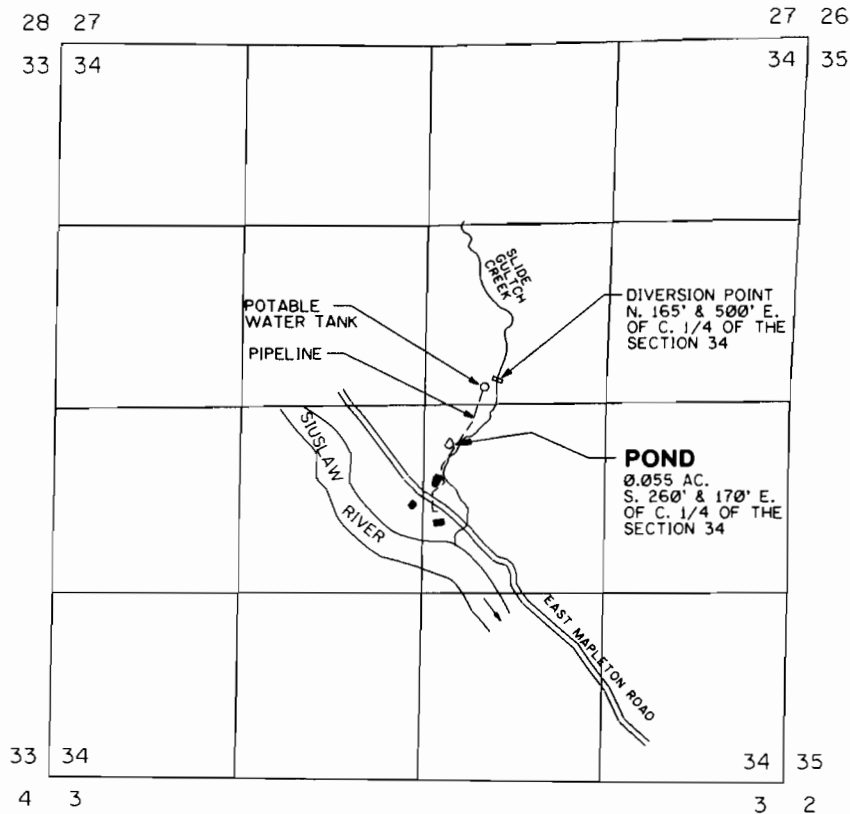

## FINAL PROOF MAP FOR STORAGE RESERVOIR

1" = 1320'

IN THE NW 1/4 OF SE 1/4 OF SECTION 34,  
T. 17S., R. 10W., W.M.  
LANE COUNTY, OREGON

FOR

GORDON A. & MARILYN CAMP

AUGUST 31, 1999

BY: MIKE MCALLISTER ENGINEERING  
11301 E. MAPLETON ROAD  
MAPLETON, OREGON 97453



**NOTE:**

THIS MAP IDENTIFIES THE LOCATION OF THE  
WATER RIGHT ONLY, AND IS NOT INTENDED TO PROVIDE  
DIMENSIONS OR LOCATE PROPERTY OWNERSHIP LINES.