

Application No. 12159
Permit No. 8896

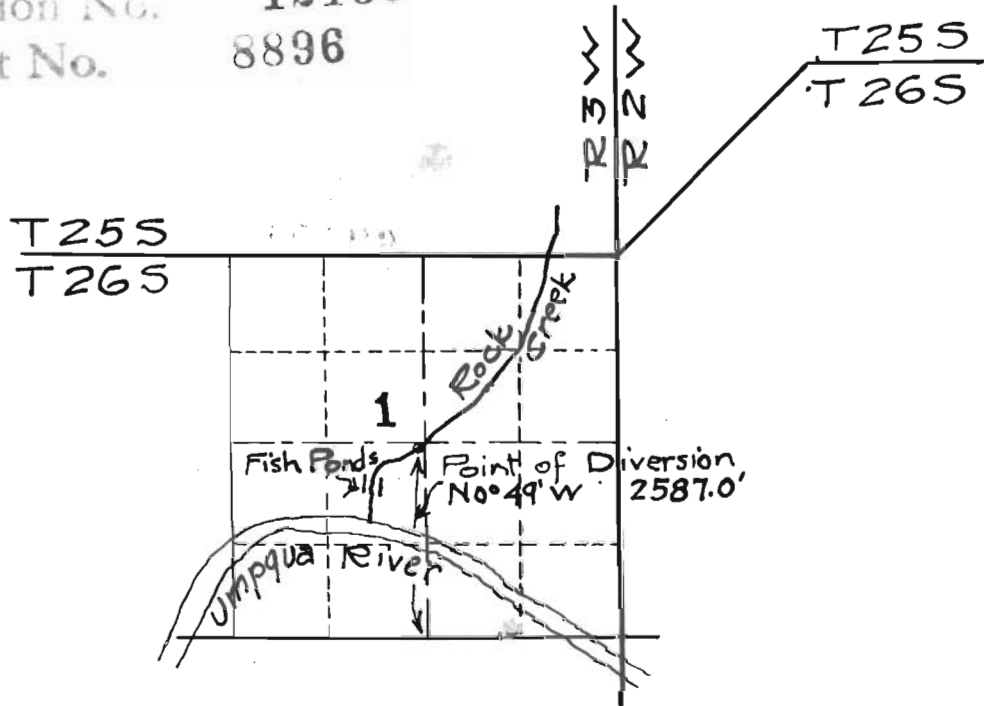

MAP OF
FISH COMMISSION ROCK CREEK
WATER FILING

Sec. 1, T 26 S R 3 W, W.M.
Douglas County Oregon

CERTIFICATE OF REGISTERED PROFESSIONAL ENGR.

I, H.L. Eppstein of Roseburg Oregon, do hereby certify that this map was made from notes taken during an actual survey under my immediate supervision in December 1928 and that it represents the work described in the accompanying application together with the streams and other ditches in the immediate vicinity.

Oregon License No. 1011
Date of Registration Nov. 8, 1920.

H. L. Eppstein
Registered Professional Engr.